

SCHEDULE OF COLUMNS:-

COLUMN MARK	DIMENSIONS	LATERAL TIES		DETAILS
		IN MIDDLE JOINT	AT END JOINT	
C1	8.25Φ	8Φ14@150C/C	8Φ14@100C/C	600

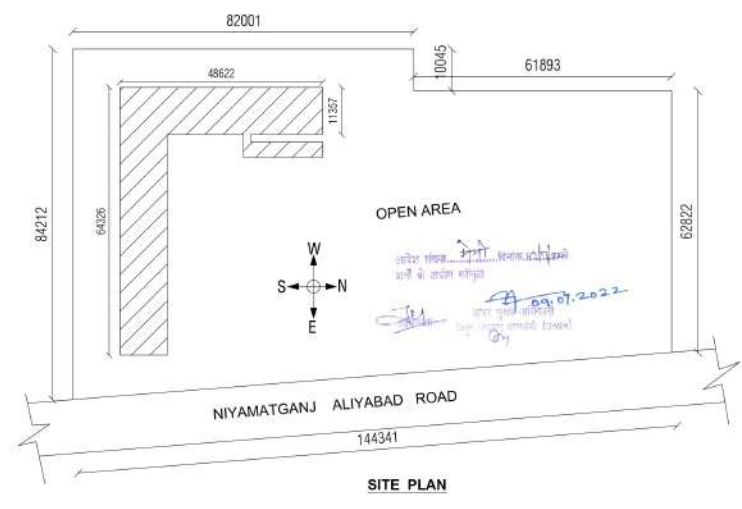
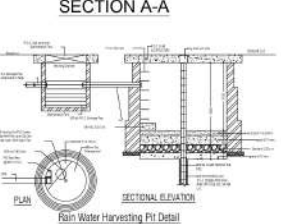
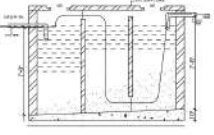
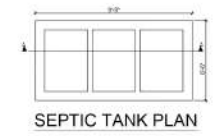
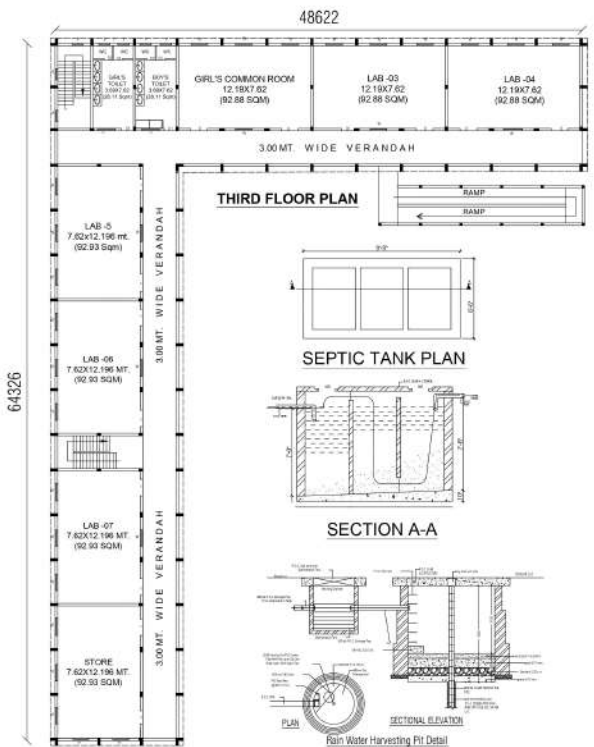

AREA STATEMENT ROOM WISE		SGM
A Instruction Area		
1. CLASS ROOM -1		92.93
2. CLASS ROOM -2		92.93
3. TUTORIAL ROOM		34.82
4. LAB -1		92.88
5. LAB -2		92.88
6. LAB -3		92.88
7. LAB -4		92.93
8. LAB -5		92.88
9. LAB -6		92.88
10. MUSEUM		92.93
11. COMPUTER		187.52
12. LIBRARY		187.52
13. SEMINAR HALL		158.95
14. MACHINE ROOM		92.93
B Administrative Area		
15. PRINCIPAL/DIRECTORS ROOM		61.34
16. BOARD ROOM		29.80
17. OFFICE ALL INCLUSIVE/MAIN OFFICE		187.52
18. DEPARTMENT/HOD OFFICE		29.80
19. FACULTY ROOM		61.34
20. CENTRAL STORE ROOM		30.00
21. MAINTAINANCE ROOM		14.26
22. SECURITY		10.25
23. HOUSEKEEPING ROOM		10.25
24. PANTRY FOR STAFF		10.00
25. EXAM CONTROL OFFICE		29.79
26. PLACEMENT OFFICE		29.79
C Amenities Area		
27. TOILET		224.88
28. BOY'S COMMON ROOM		92.88
29. GIRL'S COMMON ROOM		92.88
30. CAFETERIA		187.52
31. STATIONERY STORE & REPROGRAPHY		10.25
32. FIRST AID CUM SICK ROOM		10.25

TRUST :-
MAA SHARDA DEVI EDUCATIONL TRUST 175K, SHIVPUR
SHAHBAJPUR PADRI BAZAR ROAD GORAKHPUR

SITUATION :- VILLAGE - FATTAPUR KALA
TEHSIL - RAMSANEHI GHAT
DIST - BARABANKI
STATE - UTTAR PRADESH

NAME OF PROGRAMME :-
DIPLOMA IN PHARMACY

NAME OF INSTITUTION :-
BUILDING PLAN OF
M.S.D. COLLEGE OF PROFESSIONAL STUDIES

GATA NO. :- 1219, 1222
TOTAL AREA OF LAND. :- 8700.00 SQM (2.14 ACRE)

SCHEDULE OF OPENINGS				
S.NO.	TYPE	WIDTH	SILL LVL.	LINTEL LVL.
1.	D1	1800	0.00	2550
2.	D1	1200	0.00	2050
3.	D2	1000	2550	5400
4.	D3	750	2550	2540
5.	W1	1800	600	2550
6.	V	1500	1650	2550

SQM.		
1.	TOTAL PLOT AREA	8700.00
2.	COVERED AREA ON GROUND FLOOR	1238.00
3.	COVERED AREA ON FIRST FLOOR	1238.00
4.	COVERED AREA ON SECOND FLOOR	1238.00
5.	COVERED AREA ON THIRD FLOOR	1238.00
6.	COVERED AREA ON MUMTY	56.00
7.	TOTAL COVERD AREA	4960.00
8.	OPEN AREA ON GROUND FLOOR	7474.00
9.	F.A.R.	0.85%
10.	GROUND COVERAGE	14.09%

Architect
Anil Pandey
Awas Consultant
360 / 382A, B.H.S.
Gorakhpur
OWNER