

NORTH



PROJECT :

**RADHA KRISHNA
PHARMACY COLLEGE**
Vill: HASANPUR,
POST: GANJMURADABAD
Dist-UNNAO, UP
KHASRA/ GATA NO:- 521, AND 522,
TOTAL LAND FOR COLLEGE: 8101.92 SQMT
2.00 ACRE/ 0.810 HECT

OWNER :

MANAGER :- Dr. VIKAS KRISHAN KATTIYAR
S/O CHANDRASEN

R/O- GANJMURADABAD ROAD, PRATHMIK VIDYALAY,
HASANPUR MAJARA, GANJ MURADABAD, UNNAO.
PIN CODE- 241502

TOTAL LAND AREA : **8101.92 SQM**

COVERED AT GROUND : 2633.11 SQM

COVERED AT FIRST FL : 2633.11 SQM

COVERED AT TERR. : 52.74 SQM

TOTAL COVERED AREA: **5318.96 SQM**

OPEN AT GROUND : 5468.81 SQM

AREA CHART

A. ADMIN AREA

ROOM ID/ NAME	ROOM TYPE	AREA OF ROOM (SQM)	BUILDING NAME
1.	Principal Directors Office	30.41	PHARMACY
2.	Office	43.90	PHARMACY
3.	Staff Room	45.20	PHARMACY
4.	Lobby	33.25	PHARMACY

B. AMENITIES AREA

ROOM ID/ NAME	ROOM TYPE	AREA OF ROOM (SQM)	BUILDING NAME
COMMON RM BOYS.	Boys Common Room	90.40	PHARMACY
COMMON RM GIRLS.	Girls Common Room	45.20	PHARMACY
	Store Room-01	21.95	PHARMACY
	Store Room-02	21.50	PHARMACY

C. INSTRUCTIONAL AREA

ROOM ID/ NAME	ROOM TYPE	AREA OF ROOM (SQM)	BUILDING NAME
DIP-1.	Lecture Hall	90.40	PHARMACY
DIP-2.	Lecture Hall	90.40	PHARMACY
DIP MACHINE RM.	Machine Room	100.11	PHARMACY
HALL-1.	Seminar Hall	100.11	PHARMACY
LAB-1.	Laboratory	87.01	PHARMACY
LAB-2.	Laboratory	90.40	PHARMACY
LAB-3.	Laboratory	90.40	PHARMACY
LAB-4.	Laboratory	90.40	PHARMACY
LAB-5.	Laboratory	90.40	PHARMACY
	Museum Room	39.55	PHARMACY
	Aseptic Room	90.40	PHARMACY
	Library	176.50	PHARMACY

DESCRIPTION :-

SUBMISSION DRAWING

NOTE-

- | | |
|--|--|
| 1- DESIGN OF FOUNDATION IS FOR FOUR STOREYED BUILDING TAKING ALLOWABLE BEARING CAPACITY OF SOIL 10.0 T/Sq.M. AT A DEPTH OF 2'4" BELOW EXISTING GROUND LVL. - 2-MIX OF CONCRETE M20 (1:1.5:3) | 5-NOT MORE THAN HALF OF TOTAL NO. OF MAIN BARS OF COLUMN SHOULD BE OVERLAPED AT ONE SECTION. |
| 3-ALL STEEL SHOULD BE HIGH YIELD STRENGTH (DEFORMED BARS) HAVING YIELD STRESS NOT LESS THAN 415 N/Sq.Mm. | 6-THE BUILDING HAS BEEN DESIGNED FOR SEISMIC ZONE -2 AS PER IS CODE 1839(PART-1) 2002. |
| 4- CLEAR MINIMUM COVER FOR MAIN REINFORCEMENT- A- FOUNDATION 50 Mm B- COLUMN 40 Mm | 7-THE BEAM SHALL BE PROVIDED AT PLINTH LVL. |
| | 8-THE DEVELOPMENT LENGTH SHALL BE 47CDIA OF BAR TENSION AND 37CDIA IN COMPRESSION. |

(Signature)
Dr. VIKAS K. GUPTA
(B. Arch., A.I.I.A., F.I.I.V.)
CA No.-CA/2004/34673

OWNER SIGN :-

ARCHITECT SIGN :-

AYAAM ARCHITECT
ARCHITECTS & INTERIOR DESIGNERS
A-58, INDIRA NAGAR, LUCKNOW.
Mobile : 9415087811, 8299015188

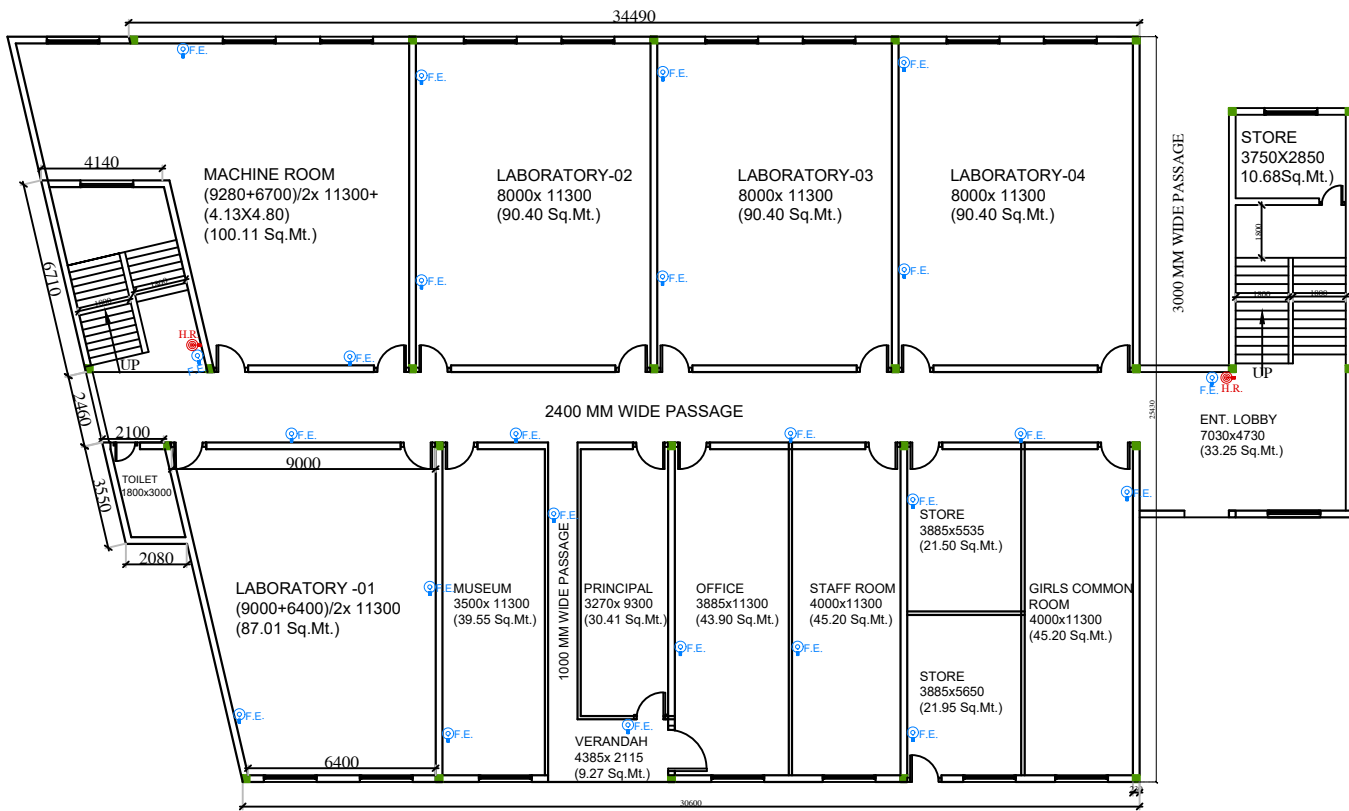

GROUND FLOOR PLAN

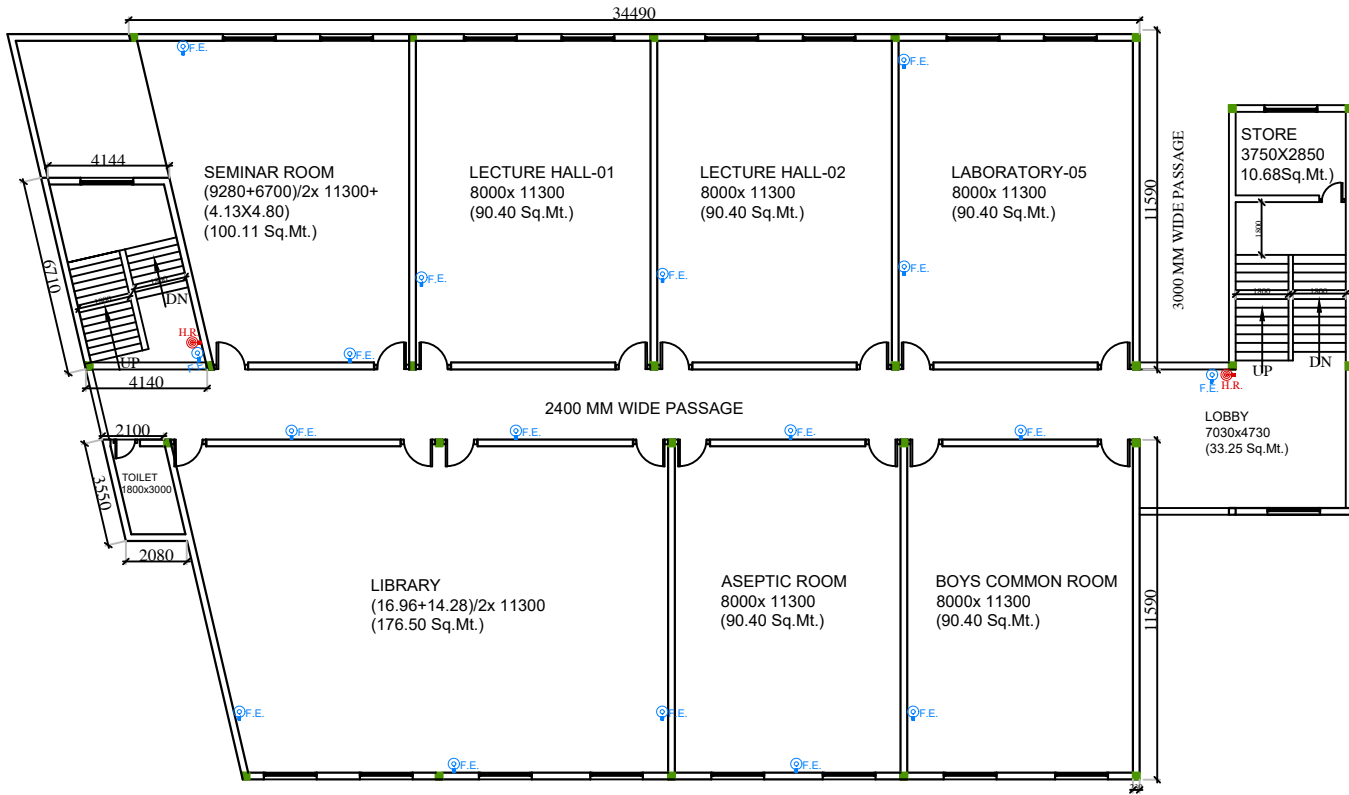

FIRST FLOOR PLAN

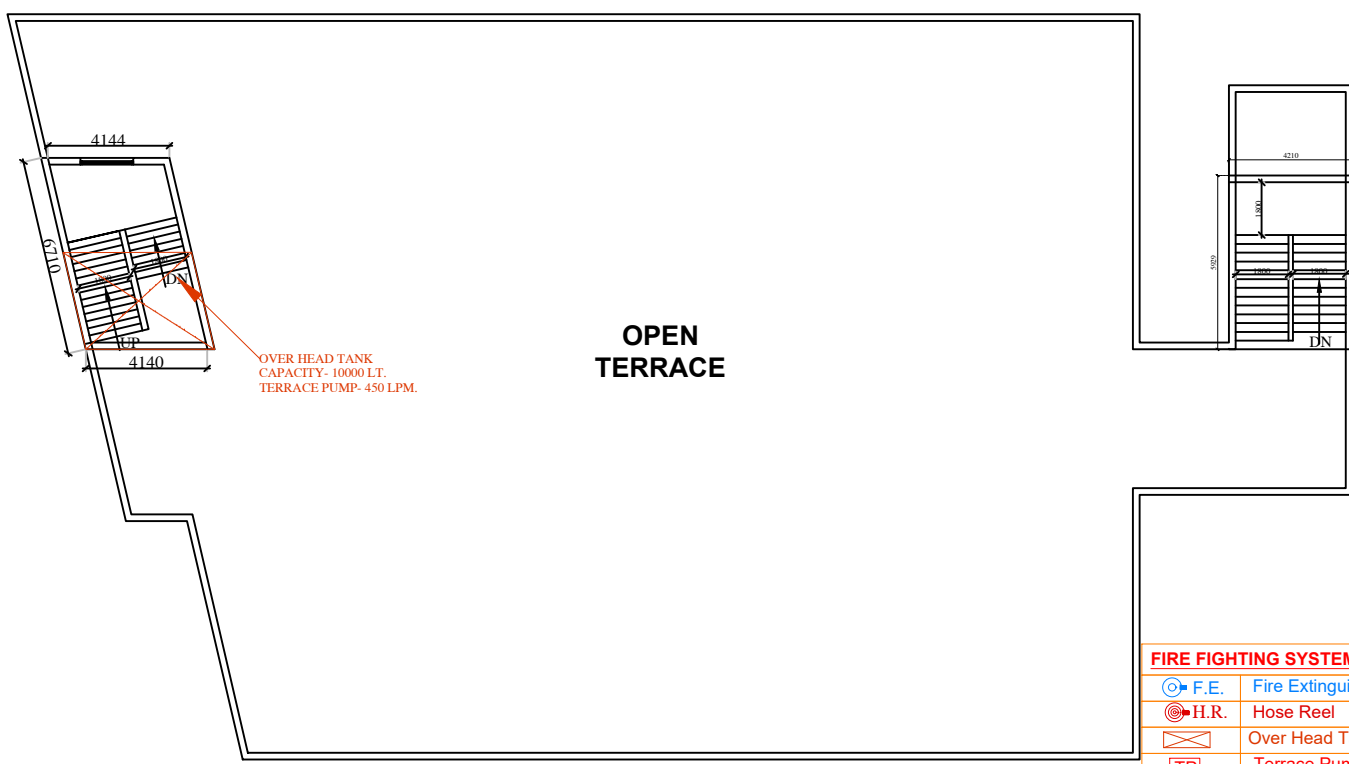

TERRACE PLAN

FIRE FIGHTING SYSTEM

- Fire Extinguisher - 41 Nos
- Hose Reel - 04 Nos
- Over Head Tank, 1 -10,000 Lt.
- Terrace Pump - 01- 450 LPM
- Sand Buckets
- Delivery Hose Box
- 100 mm Ø Pipe
- 150 mm Ø Pipe