



FRONT ELEVATION



FIRST FLOOR PLAN



SITE / KEY PLAN

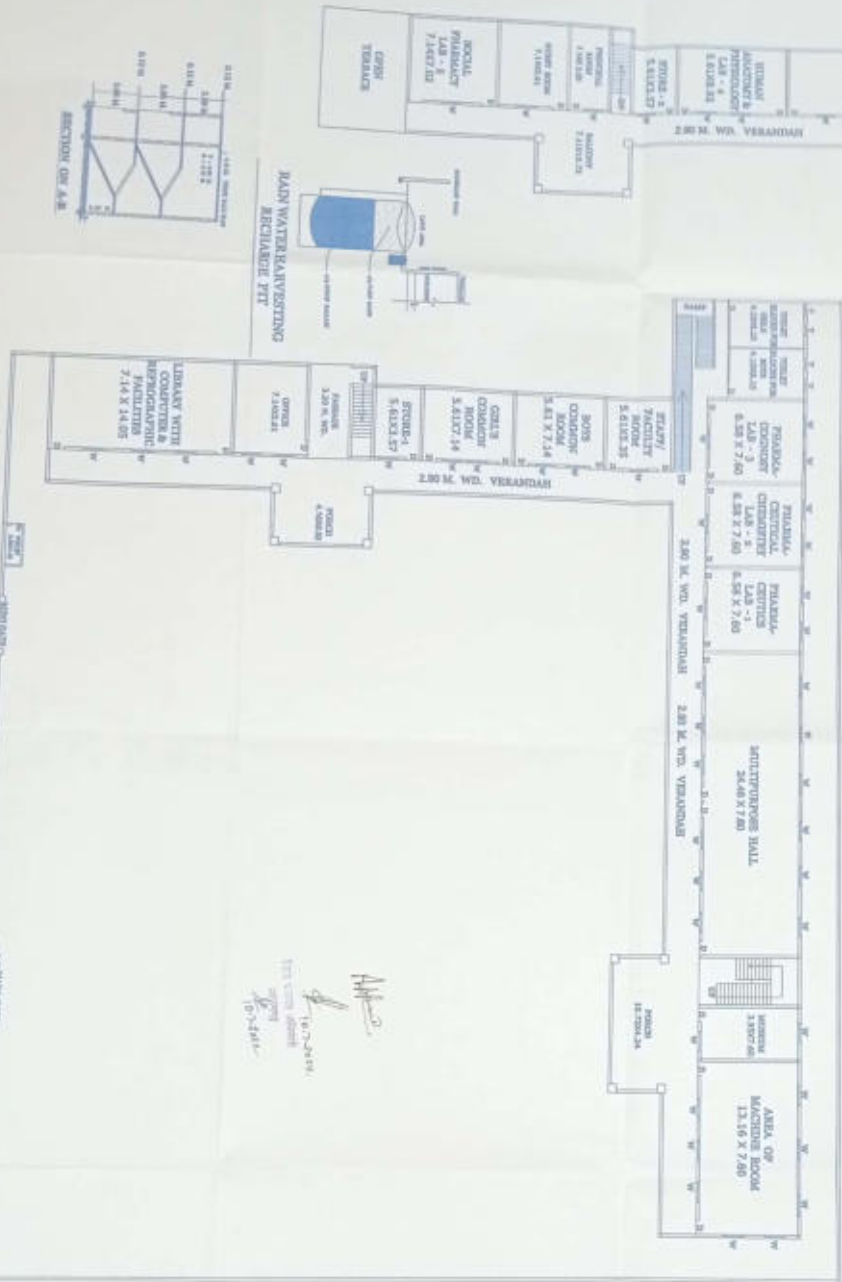

GROUND FLOOR PLAN



SECTION OF G.F.



RAIN WATER HARVESTING RECIPIABLE PIT

10/7/2019
 P. S. SAI

PLAN OF THE COLLEGE BUILDING OF
 MATA DHIRAJI COLLEGE OF PHARMACY
 AT VILL - SALEMUR, SUTANPUR
 DISTT. - AZAMGARH (U.P.) DATA NO. 282

Sl. No.	DESCRIPTION	Height Area Sq.Mt.	Area Sq.Mt.
1-	CLASS ROOM	80.00	90.00
2-	LAB	80.00	90.00
3-	LABORING ROOM	100.00	100.00
4-	LABORING ROOM	25.00	30.00
5-	STORE	20.00	20.00
6-	PHARMACY CHAMBER	20.00	22.00
7-	OFFICE	40.00	40.00
8-	STAFF ROOM	30.00	30.00
9-	LIBRARY	100.00	100.00
10-	HALL	30.00	30.00
11-	MULTIPURPOSE HALL	180.00	180.00
12-	GIRLS COMMON ROOM	40.00	40.00
13-	BOYS COMMON ROOM	20.00	20.00
14-	BOYS TOILET	20.00	20.00
15-	GIRLS TOILET	20.00	20.00

AREA CHART

TOTAL PLOT AREA	8100.00
G.F. BUILT UP AREA	1398.85
H.F. BUILT UP AREA	888.00
MUNICIPALITY CONV. AREA	55.81
TOTAL BUILT UP AREA	2280.44
OPEN AREA OR G.F.	6713.37

DETAIL OF OPENING

S.NO.	DESCRIPTION	TYPE	WIDTH	HEIGHT
1-	DOOR	D	1.05	2.10
2-	DOOR	D2	.75	2.10
3-	WINDOW	W	1.50	1.20
4-	VENTILATOR	V	.75	.45



Scale 1:200
 Date 10/7/2019
 P. S. SAI

SINK OF THE SANITARY
 DRAWN BY

Signature
 P. S. SAI
 10/7/2019