

GROUND FLOOR PLAN

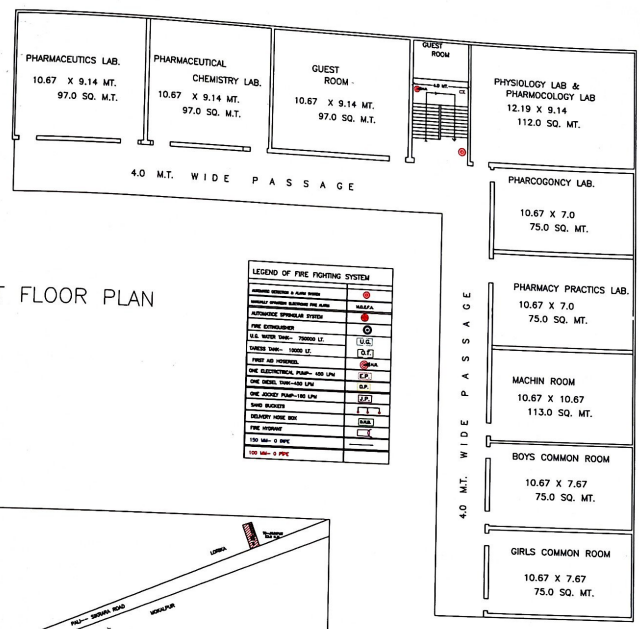

FIRST FLOOR PLAN

LEGEND OF FIRE FIGHTING SYSTEM

APPROVED SYMBOLS & PLAN SYMBOLS	N.A.S.P.A.
APPROVED SYMBOLS FOR WATER	(H <sub>2</sub> O)
APPROVED SYMBOLS FOR GAS	(G)
APPROVED SYMBOLS FOR FOAM	(F)
APPROVED SYMBOLS FOR CO <sub>2</sub>	(C)
APPROVED SYMBOLS FOR CLEAN AGENTS	(A)
APPROVED SYMBOLS FOR WATER TANK	(T)
APPROVED SYMBOLS FOR WATER TOWER	(W)
APPROVED SYMBOLS FOR WATER PUMP	(P)
APPROVED SYMBOLS FOR WATER MOTOR	(M)
APPROVED SYMBOLS FOR WATER MOTOR PUMP	(MP)
APPROVED SYMBOLS FOR WATER MOTOR PUMP TOWER	(MPT)
APPROVED SYMBOLS FOR WATER MOTOR PUMP TOWER TANK	(MPTT)
APPROVED SYMBOLS FOR WATER MOTOR PUMP TOWER TANK TOWER	(MPTTT)
APPROVED SYMBOLS FOR WATER MOTOR PUMP TOWER TANK TOWER TOWER	(MPTTTT)
APPROVED SYMBOLS FOR WATER MOTOR PUMP TOWER TANK TOWER TOWER TOWER	(MPTTTTT)
APPROVED SYMBOLS FOR WATER MOTOR PUMP TOWER TANK TOWER TOWER TOWER TOWER	(MPTTTTTT)

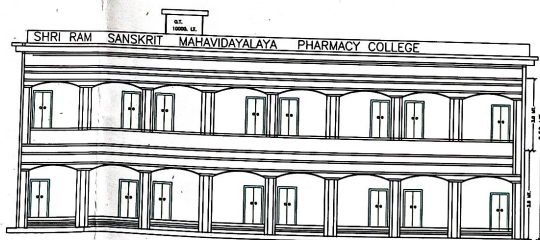
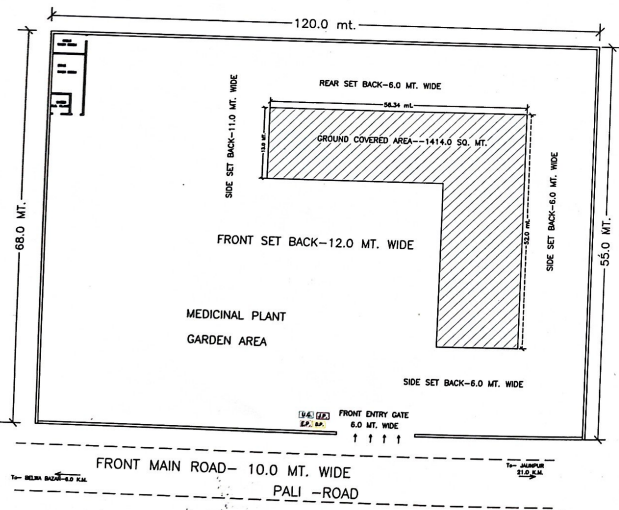
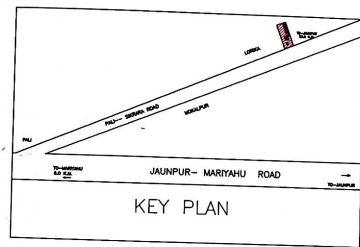

AREA STATEMENT	MT.
TOTAL PLOT AREA	8160.0 SQ. MT.
GROUND FLOOR COVERED AREA	1414.0 SQ. MT.
FIRST FLOOR COVERED AREA	1414.0 SQ. MT.
TOTAL ALL FLOOR COVERED AREA	2828.0 SQ. MT.
OPEN GROUND AREA	6746.0 SQ. MT.
MUNITY	68.0 SQ. MT.
TOTAL F.A.R.	1.2X
FRONT MAIN ROAD - 10.0 MT. WIDE	
DOOR WINDOW DETAILS	
DOOR	WINDOW
D - 1.25 X 2.13	W - 1.5 X 1.5
D1 - 0.75 X 1.82	V - 0.45 X 0.60
CAMPUS MAIN ENTRY GATE - 6.0 MT. WIDE	
CERTIFIED THAT ITS BUILDING PLAN HAS BEEN PREPARE AS BUILDING B LAW - 2008	
FIRE SAFETY WORKS AS PER N.B.C. 2016 FIRE SAFETY NORMS	
TOP SLAB FLOOR HEIGHT -	
GROUND FLOOR - 3.50 MT.	
FIRST FLOOR - 3.00 MT.	
TOTAL HEIGHT - PLINTH TO TARESS - 6.50 MT.	
APPROVAL BY -	Drawn by -
	Er. VIJAY KUMAR 6387032677 ARCHITECTURAL, CIVIL, INTERIOR CONSULTING ENGINEER JAUNPUR

EXISTING EDUCATIONAL BUILDING PLAN OF -  
**SHRI RAM SANSKRIT MAHAVIDYALAYA PHARMACY COLLEGE**  
 OPERATED BY  
**JAY BAJRANG SEVA TRUST**  
 ARAZI NO - 350  
 Village - LORIKA, MOKALPUR  
 TAHSIL - MARIYAHU  
 DIST - JAUNPUR

Sign of firm/owner  
*श्रीराम सेवा ट्रस्ट*  
 श्रीराम सेवा ट्रस्ट  
 जयबाजरांग सेवा ट्रस्ट  
 जायबाजरांग सेवा ट्रस्ट

Er. Vijay Kumar  
 Civil & Interior Consulting Engineer