

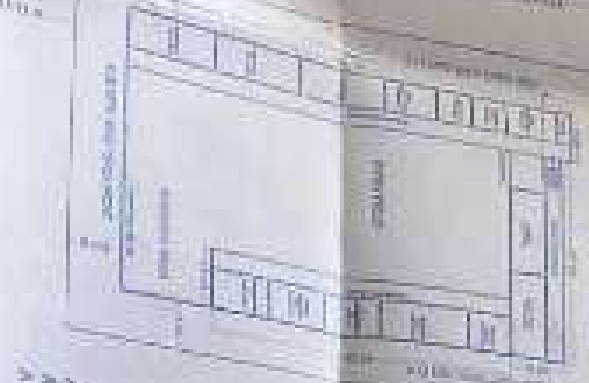

$A = 9.84 \times 24.24 + 37.23 \times 9.04 + 12.44 \times 23.26$
 $A = 294.48 + 336.23 + 288.03$
 $A = 918.74 \text{ SQUARE METERS}$

GROUND FLOOR PLAN



$A = 9.84 \times 24.23 + 37.23 \times 9.04 + 10.44 \times 23.26$
 $A = 237.00 + 336.23 + 242.00$
 $A = 815.23 \text{ SQUARE METERS}$

GROUND FLOOR PLAN

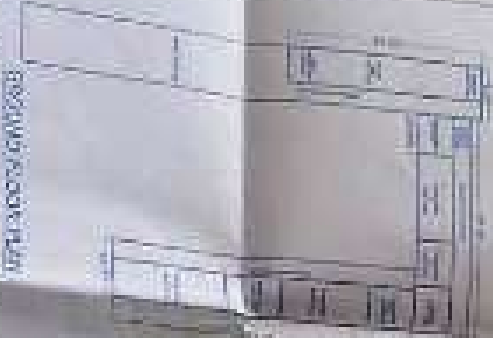

GROUND FLOOR PLAN



$A = 9.84 \times 24.23 + 37.23 \times 9.04 + 10.44 \times 23.26$
 $A = 237.00 + 336.23 + 242.00$
 $A = 815.23 \text{ SQUARE METERS}$

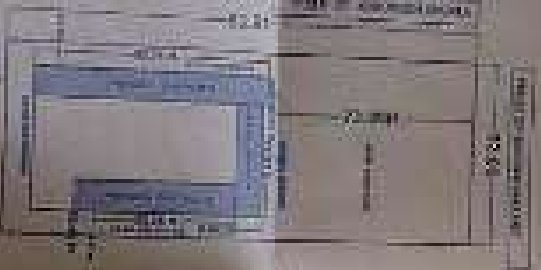

NOT PLANNED TO SCALE

1. 200 VOLT ELECTRICAL SYSTEM
 2. 200 AMP ELECTRICAL SERVICE
 3. 200 AMP ELECTRICAL SERVICE
 4. 200 AMP ELECTRICAL SERVICE
 5. 200 AMP ELECTRICAL SERVICE
 6. 200 AMP ELECTRICAL SERVICE
 7. 200 AMP ELECTRICAL SERVICE
 8. 200 AMP ELECTRICAL SERVICE
 9. 200 AMP ELECTRICAL SERVICE
 10. 200 AMP ELECTRICAL SERVICE

SET BACK DETAILS

FRONT SETBACK = 8.11 METERS WIDE
 BACK SETBACK = 5.71 METERS WIDE
 SIDE SETBACK-1 = 6.12 METERS WIDE
 SIDE SETBACK-2 = 8.11 METERS WIDE

TOTAL FLOOR

COVERED AREA ON G.P. PL.	= 1045.64
COVERED AREA ON PAVEMENT	= 1700.75
TERRACE FLOOR COVERED AREA	= 1000.00
OPEN BALCONY AREA	= 1000.00
TOTAL COVERED AREA	= 3946.39
ALL FLOOR COVERED AREA	= 3000.00

SET BACKS ON THE COLLAGE OF PHOTOGRAPHY

15.00 METERS WIDE
 10.00 METERS WIDE
 10.00 METERS WIDE
 10.00 METERS WIDE

DATE: 15/05/2018

DRAWN BY: [Signature]
 CHECKED BY: [Signature]
 APPROVED BY: [Signature]