



SITE PLAN



NOTE: THE SITE PLAN IS FOR REFERENCE ONLY. THE ACTUAL SITE PLAN IS TO BE SUBMITTED TO THE LOCAL AUTHORITY FOR APPROVAL.

TRUST - DARA JANGRI SINGH CHHINDAL TRUST
 CELL & PLOT NO. 3100R BANGHOLI KALIA, DISTRICT SULTANPUR
BUILDING FOR
BARU KAM DIAGRI SINGH COLLEGE
OF PHARMACY
 AT - PAHARGUR KALIA, KAPOREHI KALIA
 TEHSIL-KADPUR
 DISTRICT-SULTANPUR (U.P.)
 GATA NO-506, 517, 518

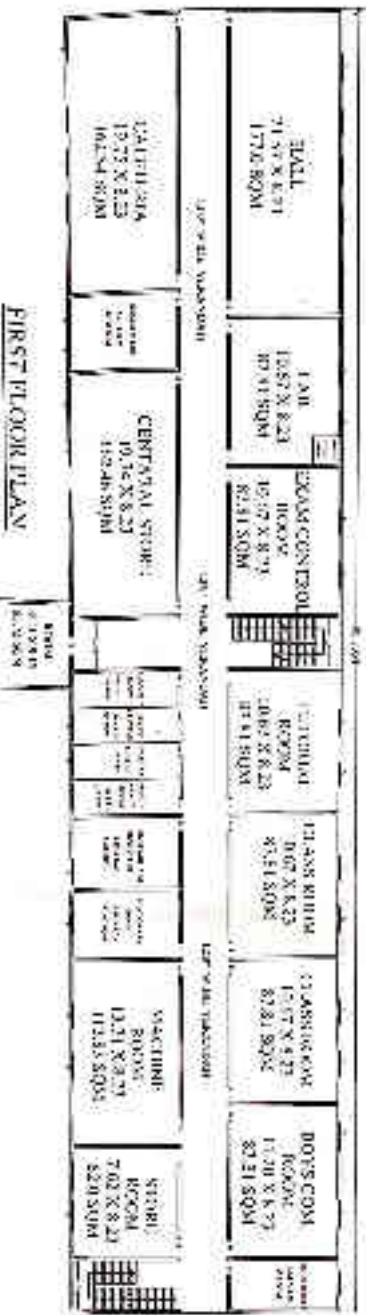

FIRST FLOOR PLAN

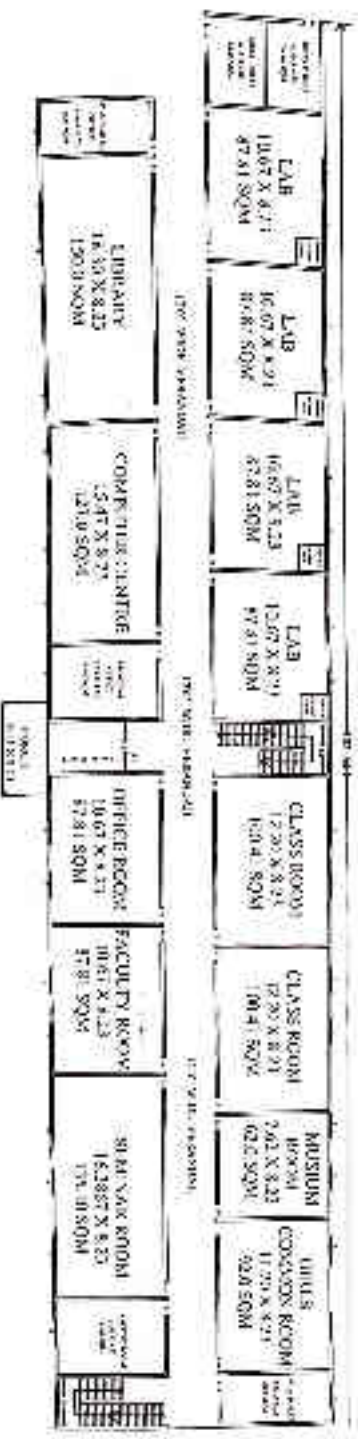

GROUND FLOOR PLAN

AREA STATEMENT

PL. NO. 414	VOLUME
0729-025	001835007
FLOOR	110.0000
GROUND FLOOR	238.25007
TOTAL FLOOR	307.25007
TOTAL AREA	480.25000
TAXES	
APPL.	

ENGINEER-ARCHITECT

Signature
 S. K. Singh
 Engineer-Architect