

GROUND FLOOR WORKING PLAN

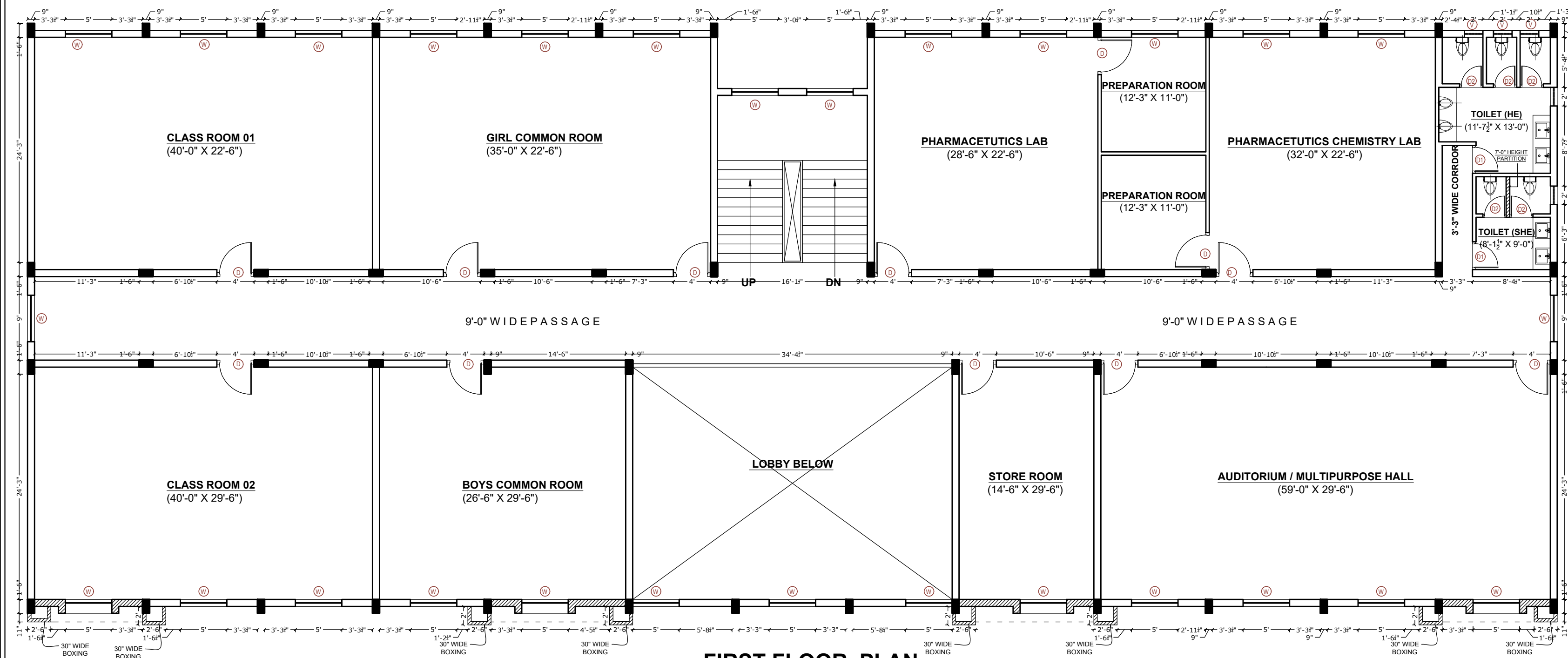

FIRST FLOOR PLAN

AREA ANALYSIS :

NOTE
 1. ALL DIMENSIONS ARE IN MM.
 2. WRITTEN DIMENSION SHALL BE FOLLOWED.
 3. ANY DISCREPANCY IN THIS DRAWING SHALL BE BROUGHT TO THE NOTICE OF THE ARCHITECT BEFORE EXECUTION.
 4. THIS DRAWING IS THE PROPERTY OF THE ARCHITECT AND SHALL NOT BE USED OR REPRODUCED WITHOUT PERMISSION.

AREA STATEMENT

1. TOTAL PLOT AREA	= 4000.00 SQ. MT.
2. GROUND COVERAGE ACHIEVED	= 23.50%
3. TOTAL COVERED AREA ON GROUND FLOOR	= 94 0.00 SQ. MT.
4. TOTAL COVERED AREA ON FIRST FLOOR	= 1014.35 SQ. MT.
5. F.A.R. ACHIEVED	= 0.48
6. MUMTY COVERED AREA	= 49.15 SQ. MT.
7. TOTAL COVERED AREA INCLUDING MUMTY	= 2003.50 SQ. MT.

TOTAL LAND AREA 4000.00 SQ.MT.

NO. OF TREES = 21 nos. TREES

NO. OF CAR PARKING = 5 nos. CARS

SCHEDULE OF OPENINGS:

S/ NO	TYPE	SIZE		SILL.		LINTEL	
		OVERALL	DOOR	DOOR	WIN.	DOOR	WIN.
1.	DW	11'-6" X 8'-0"	-	-	-	-	8'-0"
2.	D	4'-0" X 8'-0"	-	-	-	-	8'-0"
3.	D1	6'-0" X 8'-0"	-	-	-	-	8'-0"
4.	W	5'-0" X 5'-0"	-	-	3'-0"	-	8'-0"
5.	V	2'-0" X 2'-0"	-	-	6'-0"	-	8'-0"

PROJECT:

OWNED BY:

DRAWINGS

FLOOR PLANS & AREA CALCULATIONS

AREA STATEMENT	
AUDITORIUM / MULTIPURPOSE HALL	162.00 SQ.MT.
STORE ROOM	39.75 SQ.MT.
PHARMACETUTICS CHEMISTRY LAB	66.90 SQ.MT.
PHARMACETUTICS LAB	59.60 SQ.MT.
PREPARATION ROOM	12.50 SQ.MT.
PREPARATION ROOM	12.50 SQ.MT.
GIRLS COMMON ROOM	73.20 SQ.MT.
BOYS COMMON ROOM	72.60 SQ.MT.
CLASS ROOM 01	83.60 SQ.MT.
CLASS ROOM 02	109.60 SQ.MT.
LIBRARY	109.60 SQ.MT.
OFFICE	54.15 SQ.MT.
PHARMACY LAB	66.90 SQ.MT.
PHARMACY LAB	59.60 SQ.MT.
PREPARATION ROOM	12.50 SQ.MT.
PREPARATION ROOM	12.50 SQ.MT.
PREPARATION ROOM	12.50 SQ.MT.
FIRST AID ROOM	12.50 SQ.MT.
PHARMACOLOGY LAB	48.60 SQ.MT.
MUSEUM	25.00 SQ.MT.
ASEPTIC ROOM	50.15 SQ.MT.
STAFF ROOM	30.15 SQ.MT.
FACULTY ROOM	32.90 SQ.MT.
MACHINE ROOM	65.75 SQ.MT.
PRINCIPAL ROOM	52.00 SQ.MT.
ENTRANCE LOBBY	94.60 SQ.MT.

DRAWING	DIRECTION
SUBMISSION DRAWING	
PROJECT NO.	DRAWING NO.
SCALE	DRW. NO: 1/1
1:100	DATE

STUDIO A
 TOWN PLANNERS, ARCHITECTS & INTERIOR DESIGNERS
 PRINCIPAL ARCHITECT - AR. ABHJEET PRATAP SINGH MOB. 08003789850, 09452538587
 I-15 GU/JANI KANPUR, UTTAR PRADESH-208022 E-MAIL - apymmit@gmail.com

CLIENT	ARCHITECT