

OTHERS  
SITE PLAN  
SCALE 1:1000

OTHERS  
LOCATION PLAN  
SCALE NTS

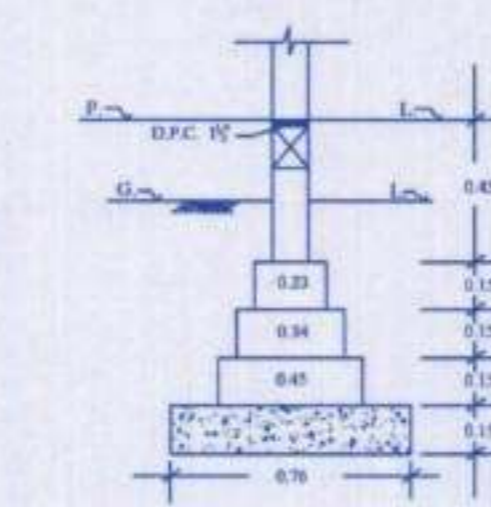

DETAIL OF BRICK FOUNDATION

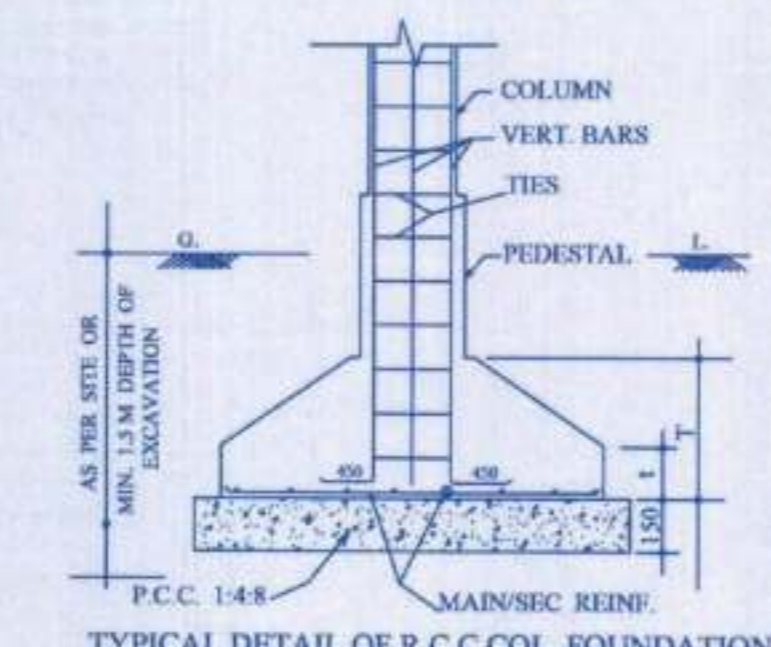
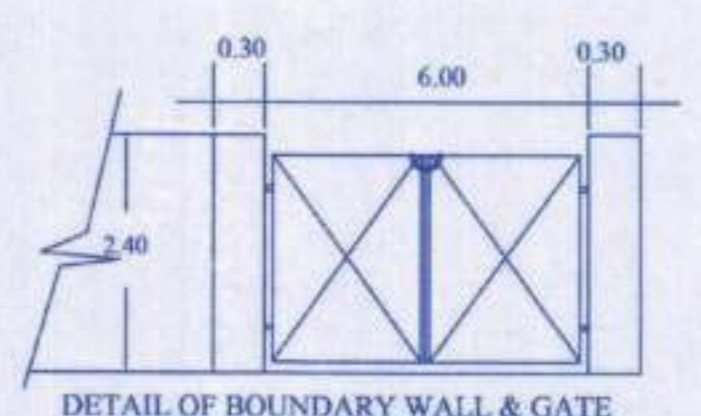
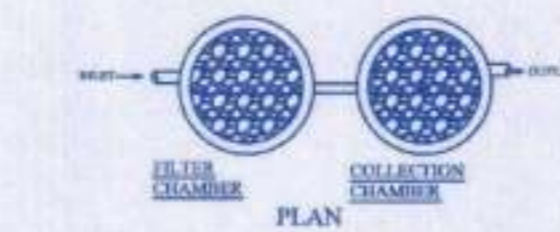

PARTICULARS OF ALL BLOCKS	AREA IN SQ.M.
TOTAL LAND AREA	12555.00
TOTAL OPEN AREA	10769.88
TOTAL CARPET AREA	2499.17
TOTAL COVERED AREA GROUND FLOOR	1785.12
TOTAL COVERED AREA FIRST FLOOR	1785.12
TOTAL COVERED AREA	3570.24
ACCESS AND CIRCULATION AREA	1071.07
PERMISSIBLE F.A.R	2.000
PROPOSED F.A.R	0.284

PROPOSED PHARMACY COLLEGE  
OF DAYAL EDUCATIONAL WELFARE SOCIETY  
VILL. SALEMPUR POST SIKANDARPUR  
TEHSIL :- CHIBRAMAU DIST. KANNAUJ

PROJECT NAME :-MAA BHAGWATI COLLEGE  
OF PHARMACY  
VILL. SALEMPUR POST SIKANDARPUR  
TEHSIL :- CHIBRAMAU DIST. KANNAUJ  
GATA NO. :- 553

प्लान नं - 354-23/2/22  
अंकित 9

मानसिंहवार  
जिला पंचायत कन्नौज

अपर अभियंता  
जिला पंचायत कन्नौज

AUTHORITY  
अभियंता  
जिला पंचायत कन्नौज

OWNER SIGN  
Sudhey

ARCHITECT'S SIGN  
A.P. SHARMA CHALMAN  
C/2018 / 10254  
R.O. :-117 / 500 PANDU NABAR  
KANPUR (U.P.)  
CONTACT:-91-995825181

23-07-2022