



GROUND FLOOR PLAN



FIRST FLOOR PLAN



ELEVATION

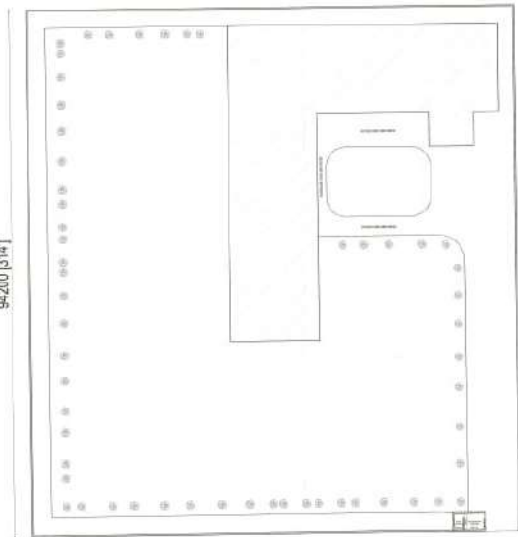

87250 (2901'10")
SITE PLAN

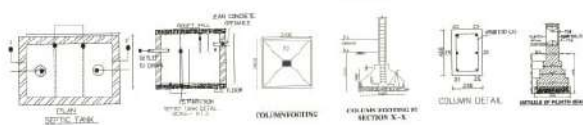

SECTION



DETAILS

TRUST:-
RAM DAS SINGH TRUST NO. 100/100/100/100
S/O. DR. BHANU SINGH
VILLAGE: JAROLI
DIST: JHANSI, M.P. 481001

SITUATION:-
PROPOSED DRAWING FOR
RAM DAS SINGH PHARMACY COLLEGE

NAME OF PROGRAM:-
D PHARM

NAME OF INSTITUTION:-
RAM DAS SINGH PHARMACY COLLEGE

KHASRA PLOT NO. 105/106

AREA STATEMENT	
1. TOTAL PLOT AREA	86100
2. COVERED AREA ON PLOT	19630
3. COVERED AREA ON PLOT	19630
4. UNCOVERED AREA	66470
5. TOTAL COVERED AREA	19630
6. % GROUND COVERAGE	22.8%
7. TOTAL PLOT AREA	86100

LEGEND

- INSTITUTIONAL AREA**
- CLASS ROOM 1 = 75 SQMT.
 - CLASS ROOM 1 = 75 SQMT.
 - LABORATORY 1 = 75 SQMT.
 - LABORATORY 2 = 75 SQMT.
 - LABORATORY 3 = 75 SQMT.
 - LABORATORY 4 = 75 SQMT.
 - LABORATORY 5 = 75 SQMT.
 - INSTRUMENT ROOM = 51.2 SQMT.
 - MACHINE ROOM = 51.2 SQMT.
 - COMPUTER ROOM = 51.2 SQMT.
 - LIBRARY = 156.8 SQMT.
- ADMINISTRATIVE AREA**
- PRINCIPAL ROOM = 10 SQMT.
 - DIRECTOR ROOM = 32.4 SQMT.
 - STAFF ROOM = 40 SQMT.
 - OFFICE = 75.2 SQMT.
 - PANTRY = 10.2 SQMT.
- AMENITIES**
- BOYS COMMON ROOM = 75 SQMT.
 - GIRLS COMMON ROOM = 75 SQMT.
 - DEBENTH HALL = 130 SQMT.
 - REST AND ROOM = 15 SQMT.
 - MUSEUM = 81.2 SQMT.

NORTH N SCALE 1/500

ARCHITECT SIGN OWNER SIGN

DATE: 10/10/2024
PROJECT: RAM DAS SINGH PHARMACY COLLEGE
DRAWN BY: [Name]
CHECKED BY: [Name]
SCALE: 1/500