

GROUND FLOOR PLAN

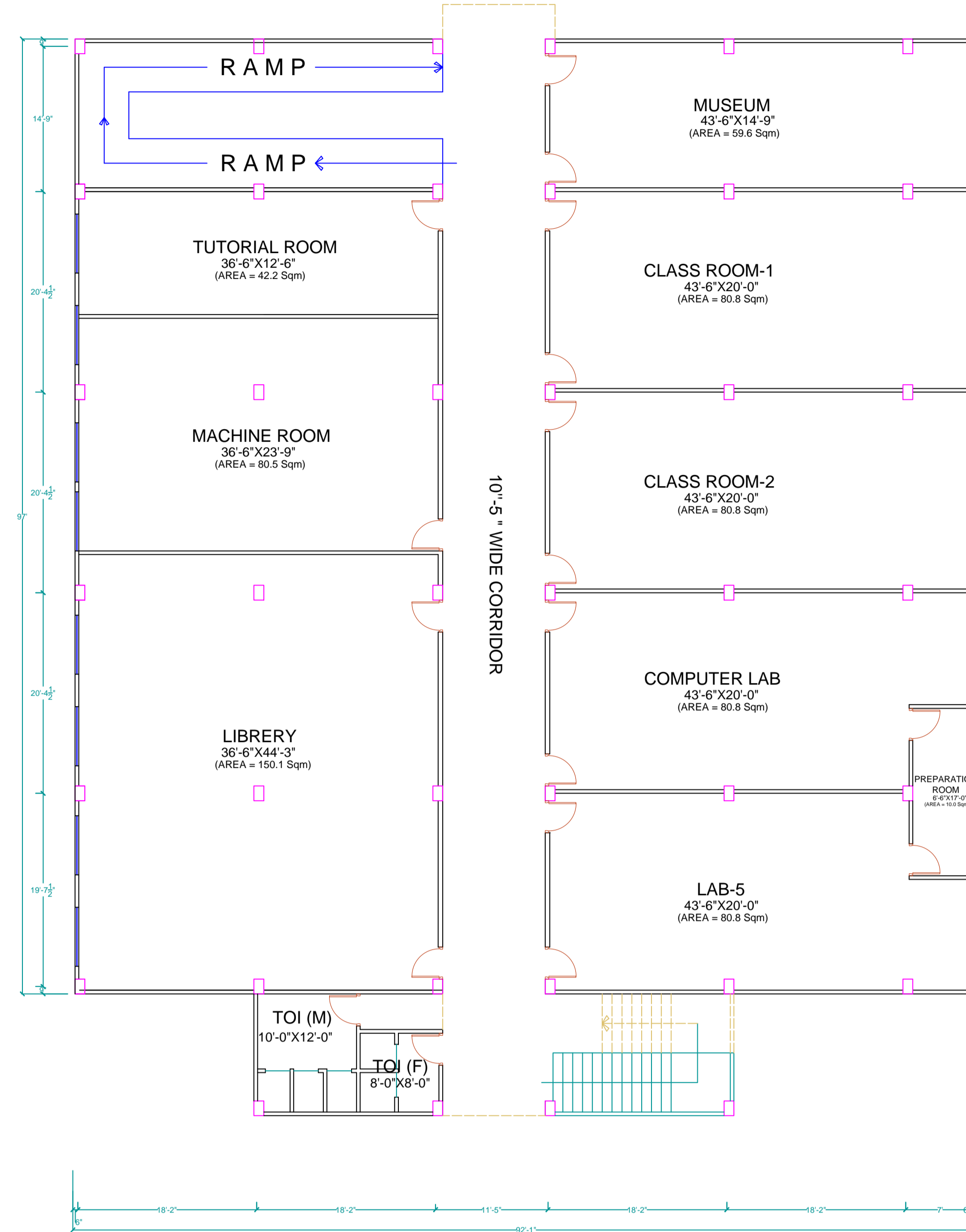

FIRST FLOOR PLAN

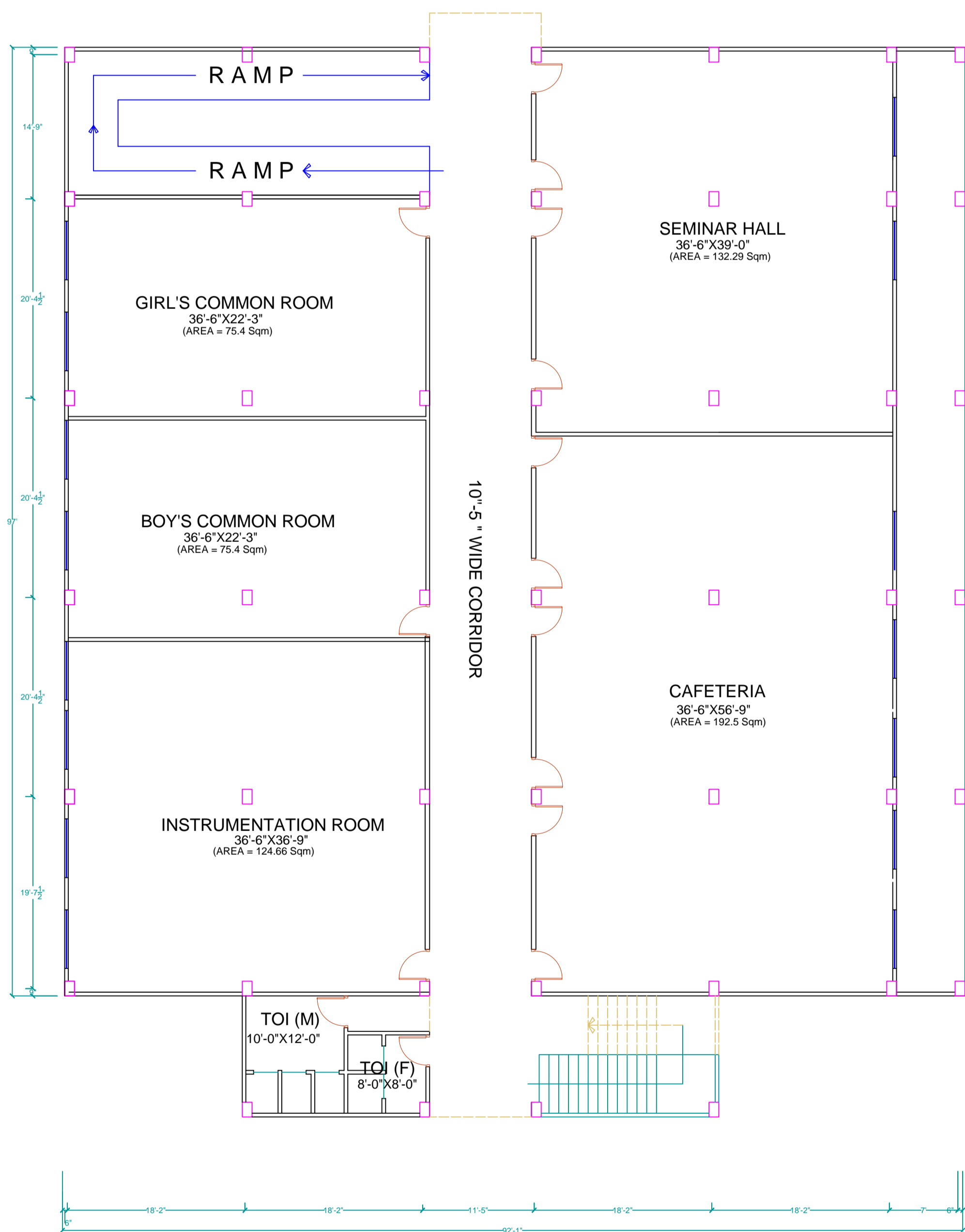

SECOND FLOOR PLAN

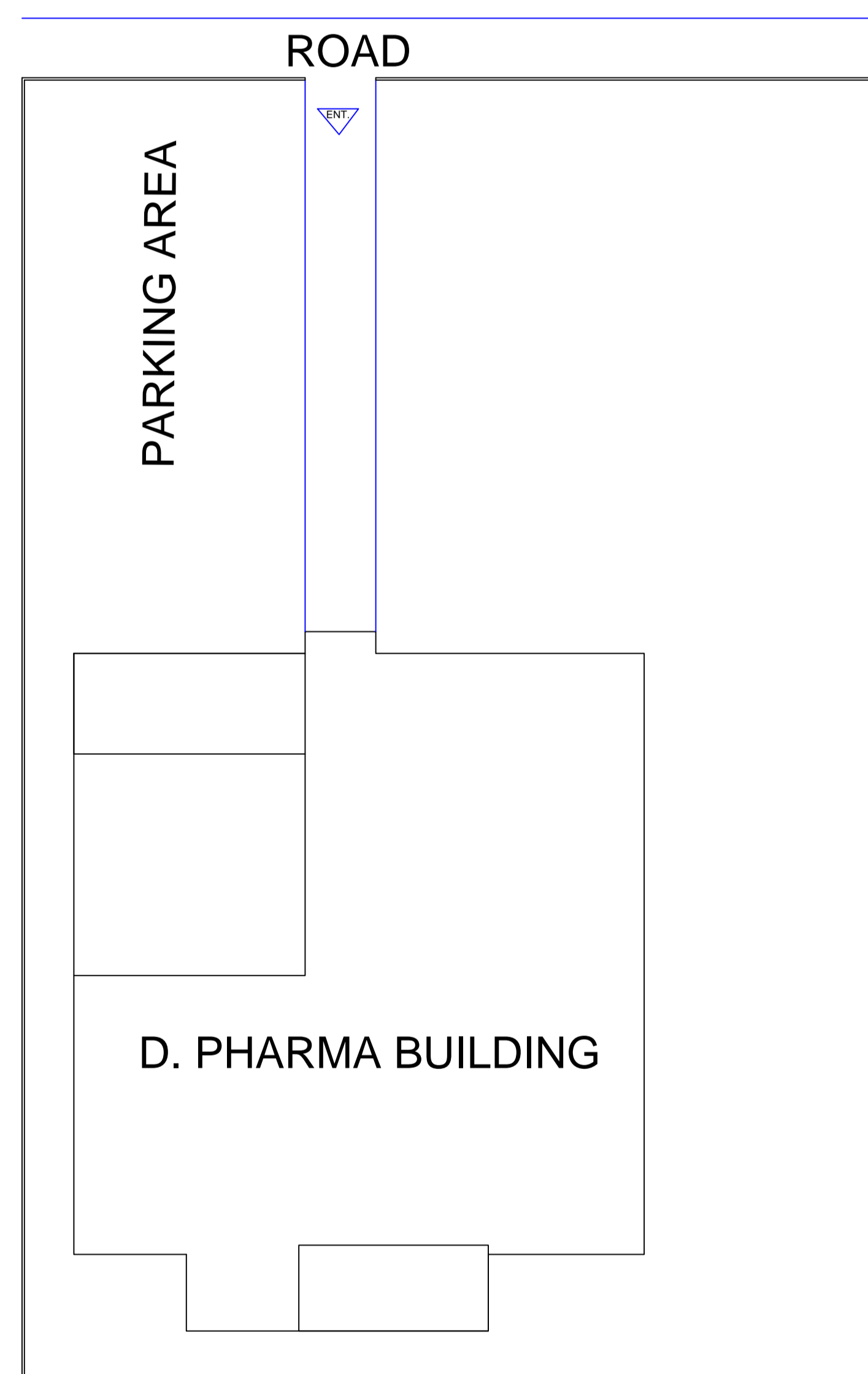

SITE PLAN

PROPOSED  
 VIDYAVATI INSTITUTE OF PHARMACY  
 AT LAND PORTION OF ARAZI No. 827  
 AT ALLAHABAD MIRZAPUR ROAD, BENDO,  
 KARCHHANA, ALLAHABAD, UTTAR PRADESH

SPECIFICATION

LIME CONC. IN FOUNDATION	1 : 4 : 8
B/W IN C. MORTAR & S/S	1 : 6
R.C.C. WORK	1 : 2 : 4
25 MM THICK D.P.C.	1 : 1.5 : 3
C. PLASTER	1 : 4 OR 1 : 6

AREA STATEMENT FOR POLYTECHNIC

TOTAL PLOT AREA (2 Acre)	8093.7 SQM
COVD. AT G.F. (BLOCK-A)	889.89 SQM
COVD. AT F.F. (BLOCK-A)	889.89 SQM
COVD. AT S.F. (BLOCK-A)	889.89 SQM
TOTAL FLOOR AREA	2669.67 SQM
TOTAL OPEN AREA	7203.81 SQM

NOTE:

DOOR/ WINDOW SCHEDULE

D	3.00 X 2.7
D1	1.2 X 2.7
D2	0.75 X 2.7
D3	0.91 X 2.7
W	2.4 X 1.8
W1	2.1 X 1.8
W2	1.5 X 1.8
V	0.91 X 0.91

SIGNATURE OF DEVELOPMENT AUTHORITY

SIGNATURE OF CLIENT

SIGNATURE OF ARCHITECT

MANISH ARCHITECT & ASSOCIATES  
 ARCHITECTURE PLANNING INTERIORS

23/5 C.Y., CHINTAMANI ROAD  
 GEORGE TOWN  
 ALLAHABAD  
 PH- 9839450062

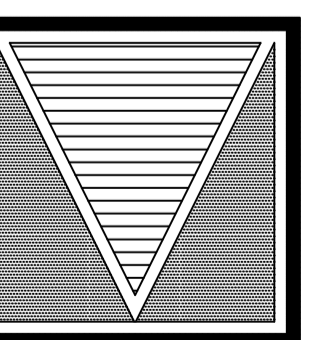

TITLE  
 DRAWING FOR VIDHYAVATI INSTITUTE OF  
 PHARMACY, BENDO, KARACHHANA, ALLAHABAD

DRAWN BY MANISH	REVISIONS			REVISED BY
	R. NO.	DATE	DESCRIPTION	
CHECKED BY MANISH				
ACAD FILE NAME				
REVISION NO.				

PROJECT FOR  
 PHARMACY INSTITUTE

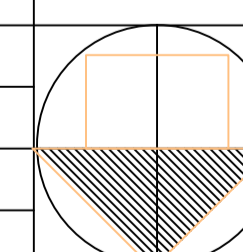

CLIENT : SHREE RAM LAKHAN  
 SMARAK TRUST  
 PLACE  
 BENDO, KARACHHANA, ALLAHABAD, U.P.

SCALE  
 1/4" = 1'-0"  
 DATE  
 DEC 18, 2011

THIS DRAWING IS A COPYRIGHT, AND PROPERTY OF THE ARCHITECT  
 THIS SHOULD NOT BE REPRODUCED, COPIED OR HANDED OVER TO  
 A THIRD PARTY AND SHOULD NOT BE USED FOR ANY PURPOSE OTHER  
 THAN FOR WHICH IT HAS BEEN LOANED