

PLOT NO -7

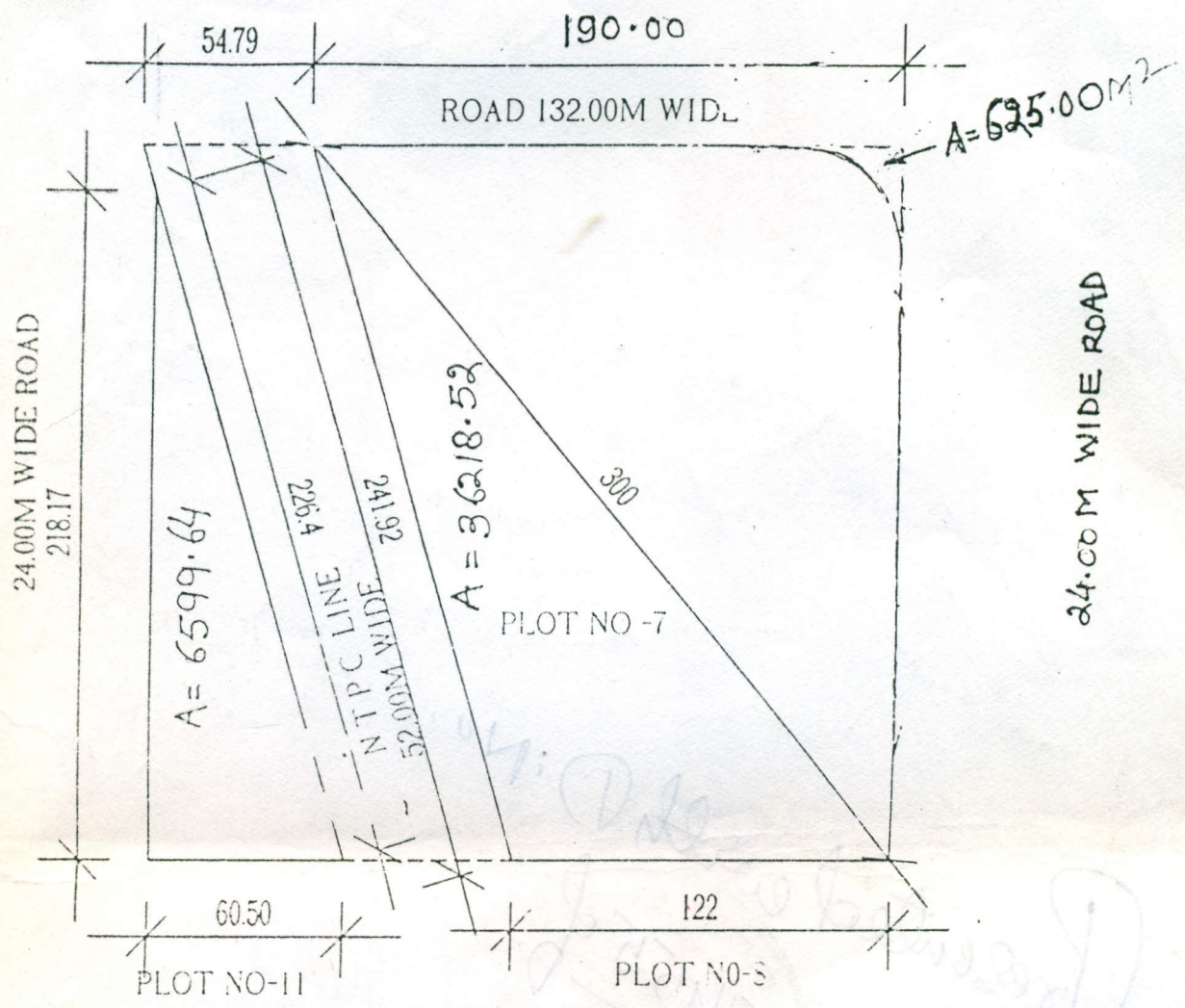

$$36218.52 + 6599.64 - 625.00 = 42193.16 \text{ m}^2$$

AREA:

SIGN- POSSESSION TAKEN OVER ALLOTEE	SIGN- POSSESSION HANDED OVER ALLOTEE	
LEASE PLAN ON PLOT NO-7, AT KNOWLAGDE PARK.	<i>S. Mani</i> ASST MRG(ENGG)	<i>Ch. J. S.</i> MRG(ENGG) 2/12/2000
GREATER NOIDA DEVELOPMENT AUTHORITY	SMI ENGG	DRAFTSMAN

For Greater Noida Institute
of Technology

Chairman
Chairman

K. D. Mani
K. D. MANI
Management Trainee (Prop.)
Greater Noida Indl Dev. Authority
H-169, Sector-Gamma II, Greater Noida
Distt. Gautam Buddha Nagar (U.P.)

Presented with D. No.

