

EXISTING GROUND FLOOR AND FIRST FLOOR PLAN OF R. B. S. MAHAVIDHYALAYA DEPARTMENT OF PHARMACY SITUATED AT ALIGANJ - BADAUN BYPASS ROAD SHYAM NAGAR PATIYALI DISTT. KASGANJ. SECRETARY :- MR. RAM BILASH SINGH

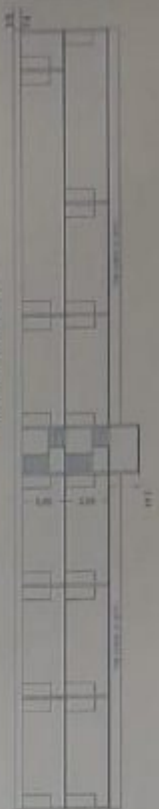

SECTION AT A-A



GROUND FLOOR PLAN



FIRST FLOOR PLAN

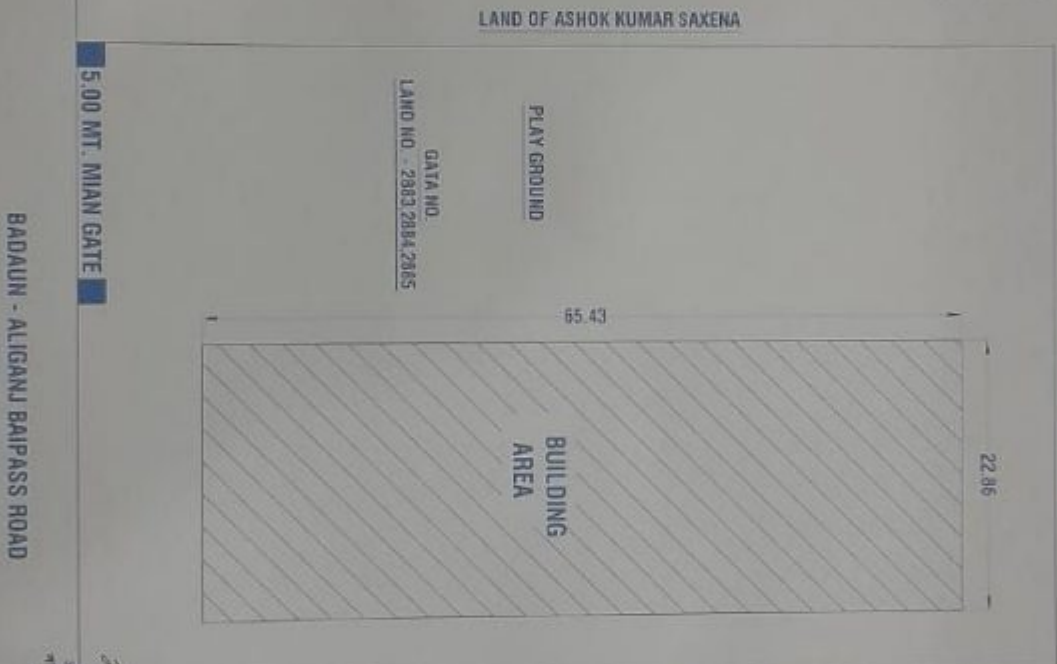

SITE PLAN

1. TOTAL LAND AREA
2. GROUND F. COVD. AREA
3. GROUND F. OPEN AREA
4. FIRST FLOOR COVD. AREA
5. TOTAL BUILDING AREA

SECRETARY SIGN.

AREA CHART	
SQMT.	SQFT.
5400.00	58064.51
1495.72	16083.01
3904.27	41981.50
1495.72	16083.01
2991.44	32166.02

DRAWN BY



DIRECTION

Secretary
R. B. S. Mahavidyalaya
Department of Pharmacy
Patiyali (Kasganj)

MR. PAVAN KUMAR
(B.Tech. M.V., C.E.)
Regd. No. 8, 16/17 Et.
Old S.M.I. Compound, Etah
825014/12095222