

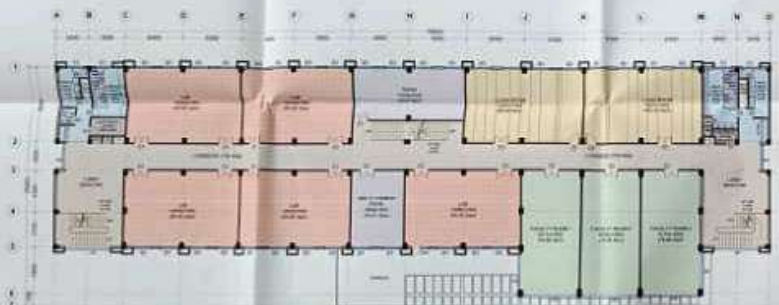

**SECOND FLOOR PLAN**- Scale 1:200



**FIRST FLOOR PLAN**- Scale 1:200



**GROUND FLOOR PLAN**- Scale 1:200



**FRONT ELEVATION**- Scale 1:250

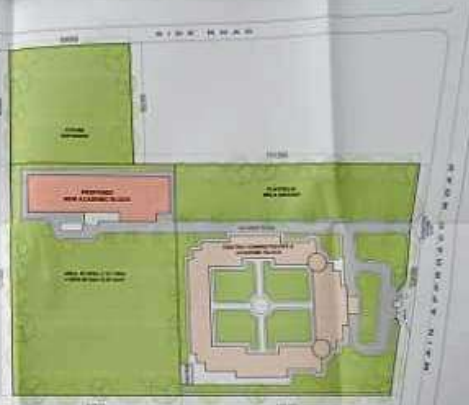

**SITE PLAN**  
Scale 1:1000

**DOOR WINDOW SCHEDULE**

SL. NO.	TYPE	AREA (SQ. MTR)	PERCENTAGE
1	Door	150	1.5
2	Window	150	1.5
3	Door	100	1.0
4	Window	100	1.0
5	Door	100	1.0
6	Window	100	1.0
7	Door	100	1.0
8	Window	100	1.0
9	Door	100	1.0
10	Window	100	1.0

**AREA SCHEDULE**

FLOOR	FLOOR AREA (SQ. MTR)	PERCENTAGE
GROUND FLOOR	10000	100.0
FIRST FLOOR	10000	100.0
SECOND FLOOR	10000	100.0
<b>TOTAL GROUND</b>	<b>30000</b>	<b>100.0</b>
<b>TOTAL FLOOR AREA</b>	<b>30000</b>	<b>100.0</b>
<b>MINIMUM COVERED</b>	<b>30000</b>	<b>100.0</b>

PROJECT  
**PROPOSED ACADEMIC BLOCK**  
for  
**DHAURAHRA VIKAS SANSTHAN** at  
**Rasoolpur, Lakhimpur- (U.P.)**



ARCHITECTURAL CONSULTANTS



ORIENTATION



DRAWN BY  
SS

CHECKED BY  
RS

- GENERAL:**
1. I engage and hold responsibility of this drawing to have been prepared in accordance with the latest code of practice and standards in effect at the time of preparation.
  2. All dimensions are in millimeters unless stated otherwise.
  3. Typical construction details to be as per specifications in contract documents.
  4. All dimensions shown on this drawing are to be as shown, unless otherwise stated.
  5. The drawing is to be used in accordance with all other relevant construction documents and specifications.
  6. All structural works are to be carried out in accordance with IS:456:2000 and IS:800:2009, National Specification for Structural Steel.

DRAWING NAME:  
SUBMISSION DRAWING

SCALE	SHEET	DATE	REV.
As Shown	A1	06/01/19	
DRAWING No.: SU 01			

Shot on OnePlus  
Lakhimpur Kheri, Uttar Pradesh, 2022.08.24 21:06  
By Ashish