

FOR OFFICE USE:-

Handwritten notes and signatures in the top right corner, including a signature and the name 'GAURAV AGARWAL ARCHITECT'.

SPECIFICATIONS:-

AREA CHART :-	AREA'S (SQMT.)	PER %	REMARKS
TOTAL LAND AREA	10,360.11	100 %	2.56 ACRE
COVD. AREA ON G. FL.	2150.30	20.75 %	R.C.C. ROOF
COVD. AREA ON F. FL.	2074.40		R.C.C. ROOF
COVD. AREA ON MUMTY	120.80		3 NOS, R.C.C ROOF
TOTAL COVERED AREA	4345.50		

North arrow pointing up, labeled 'N'.
 SCALE: 1:200
 SHEET NO. 01
 DATE: Sep. 2016

SUBMISSION DRAWING
 This is to certify that the drawing:
 1. is prepared as per the Bye-Laws
 2. the title is correct and clear

CLIENT:-
 MR. GAURAV RAJPUT
 THAKURDWARA, U.P.

ARCHITECT'S SIGN. :-
 ARCHITECT SIGN. :-
 ARCHITECT: ARCH. UNITED DESIGNS
 ARCH. GAURAV AGARWAL

ARCHITECTS INTERIOR DESI. LANDSCAPE CONSULTANTS
 OPP. - BHARAT GAS AGENCY,
 HASANPUR ROAD, GARAULA
 MOB: 9897345010, 9711065050

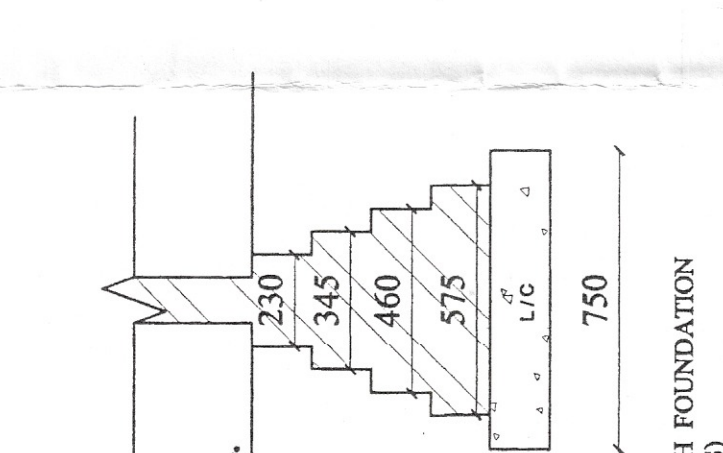
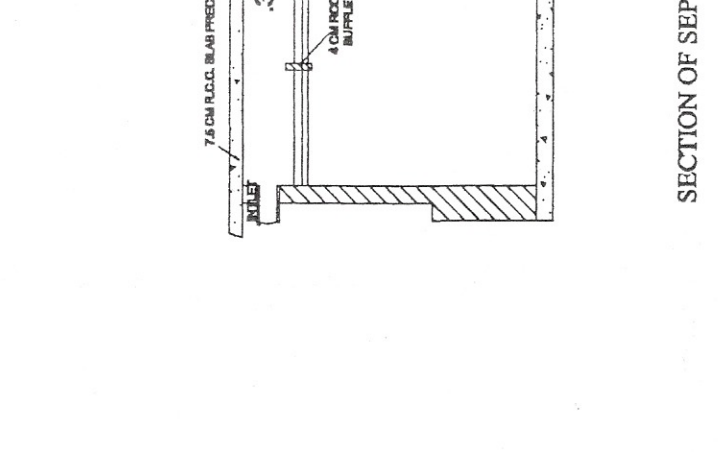
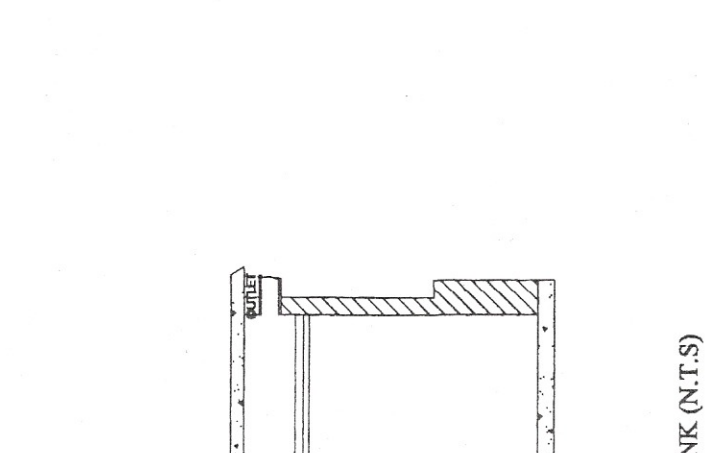
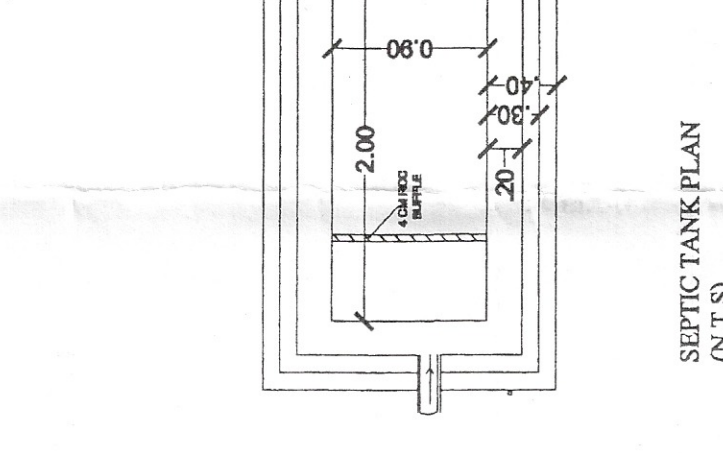
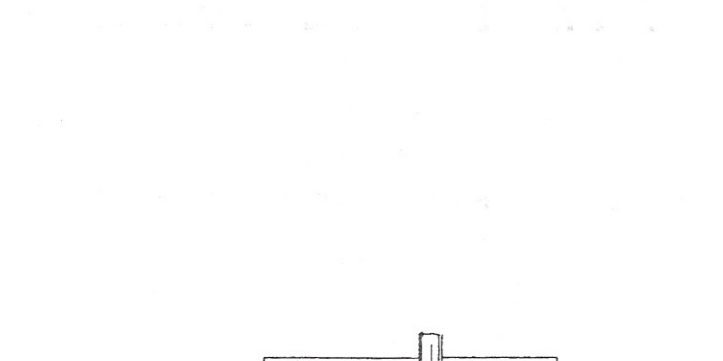
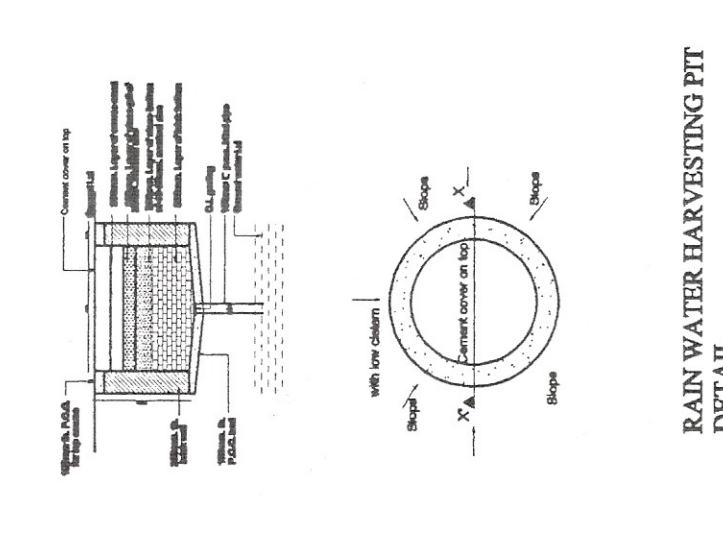
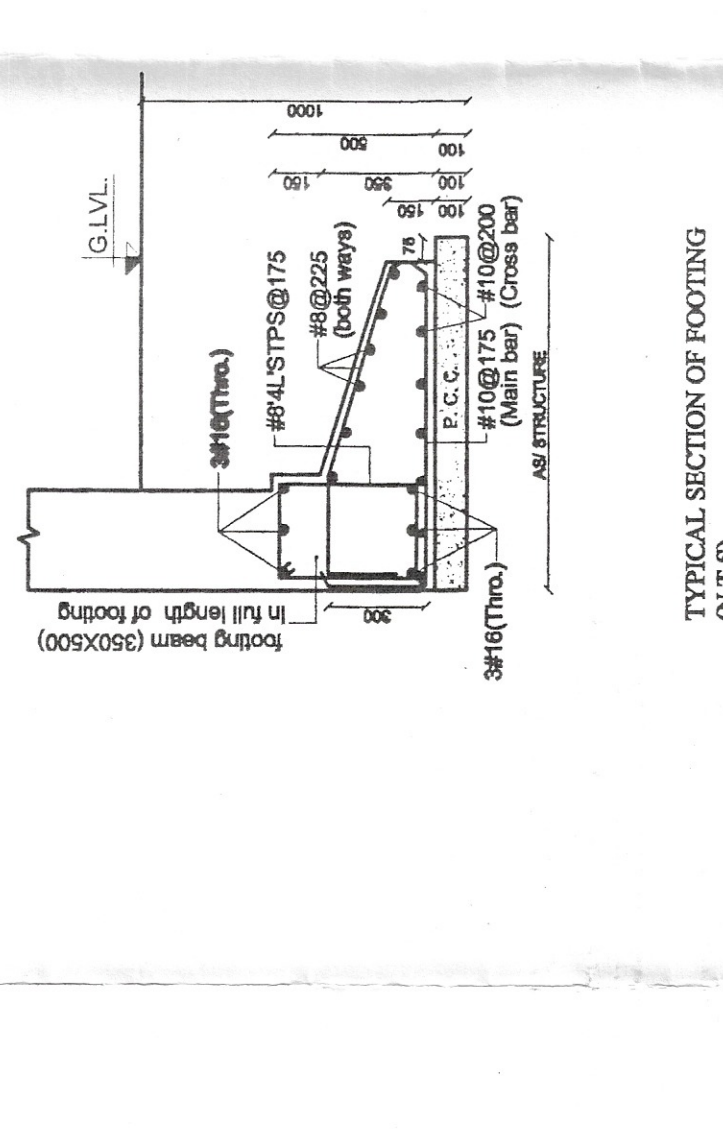

BUILT-UP AREA CALCULATION:
 1. TOTAL LAND AREA = 10,360.11 SQMT. / 2.56 ACRE
 2. INSTRUCTIONAL AREA (INA): = 1404.80 SQMT.
 3. ADMINISTRATIVE AREA (ADA): = 895.30 SQMT.
 4. AMENITIES AREA (AMA): = 672.90 SQMT.

5. CIRCULATION AREA (CIA): = 2573.00 SQMT. (Desired)
 = 2573.00 / 1.43 = 1799.30 SQMT. (Given)
 6. TOTAL BUILT-UP AREA: = (INA+ADA+AMA)+(CIA) = (2973.00 + 1372.50) = 4345.50 SQMT.



KEY PLAN (N.T.S.)

SITE PLAN (1:200)

EXISTING BUILDING MAP PLAN FOR D. PHARMA COURSE OF :

DHARAMVEER SINGH MEMORIAL COLLEGE OF PHARMACY, SITUATED AT:-
 VILL.:- USMANPUR, POST:- SULTANPUR DOST, PLOT NO.:- 10/2, 11-A, 11-B;
 KASHIPUR - MORADABAD NATIONAL HIGHWAY, TEHSIL:- THAKURDWARA
 DISTT :- MORADABAD - 244001, UTTAR PRADESH

NOTE:-
 All the Dimensions are in Millimeters as or otherwise Specified.
 All the Areas are in Square Meters as or otherwise Specified.