

NOTES

1. THE CONTRACTOR SHALL PROVIDE ALL MATERIALS AND SERVICES FOR THE CONSTRUCTION OF THE BUILDING. THE CONTRACTOR SHALL BE RESPONSIBLE FOR OBTAINING ALL NECESSARY PERMITS AND APPROVALS FROM THE APPROPRIATE AUTHORITIES. THE CONTRACTOR SHALL BE RESPONSIBLE FOR THE PROTECTION OF ALL EXISTING UTILITIES AND STRUCTURES. THE CONTRACTOR SHALL BE RESPONSIBLE FOR THE PROTECTION OF ALL EXISTING TREES AND LANDSCAPE. THE CONTRACTOR SHALL BE RESPONSIBLE FOR THE PROTECTION OF ALL EXISTING ROADS AND DRIVEWAYS. THE CONTRACTOR SHALL BE RESPONSIBLE FOR THE PROTECTION OF ALL EXISTING UTILITIES AND STRUCTURES. THE CONTRACTOR SHALL BE RESPONSIBLE FOR THE PROTECTION OF ALL EXISTING TREES AND LANDSCAPE. THE CONTRACTOR SHALL BE RESPONSIBLE FOR THE PROTECTION OF ALL EXISTING ROADS AND DRIVEWAYS.

PROPOSED SAI COLLEGE OF PHARMACY
OF SRI SAI JAMSEVA NYAS
SITUATED PLOT/GATE NO.150, AT SIKTHUA,
KANNADANPUR, MADURAI DISTRICT,
DISTRICT-INDIA (T.N.)

PHARMACY BLOCK BUILDUP AREA
AREA OF GROUND FLOOR 1142.74 SQM
AREA OF FIRST FLOOR 1142.74 SQM
AREA OF SECOND FLOOR 1173.74 SQM
TOTAL BUILDUP AREA 3459.22 SQM

DOOR/WINDOW SCHEDULE

S.No	TYPE	SIZE	CALL LVL.	LIMIT LVL.
1	D	1700x2400	+0.00	2400
2	D	1500x2150	+0.00	2150
3	D	900x2150	+0.00	2150
4	D	1350x2150	+0.00	2150
5	D	1000x2150	+0.00	2150
6	D	1000x2150	+0.00	2150
7	D	1000x2150	+0.00	2150
8	D	1000x2150	+0.00	2150
9	D	1000x2150	+0.00	2150
10	D	1000x2150	+0.00	2150

SCALE: 1/4" = 1'-0"
DATE: 10/10/2018
DRAWN BY: [Signature]

SHEET NO. 02

ARCHITECTS: A.S. ANILKumar
CHARTERED ARCHITECTS
INDIAN INSTITUTE OF ARCHITECTS
MEMBER

SECOND FLOOR PLAN

FIRST FLOOR PLAN

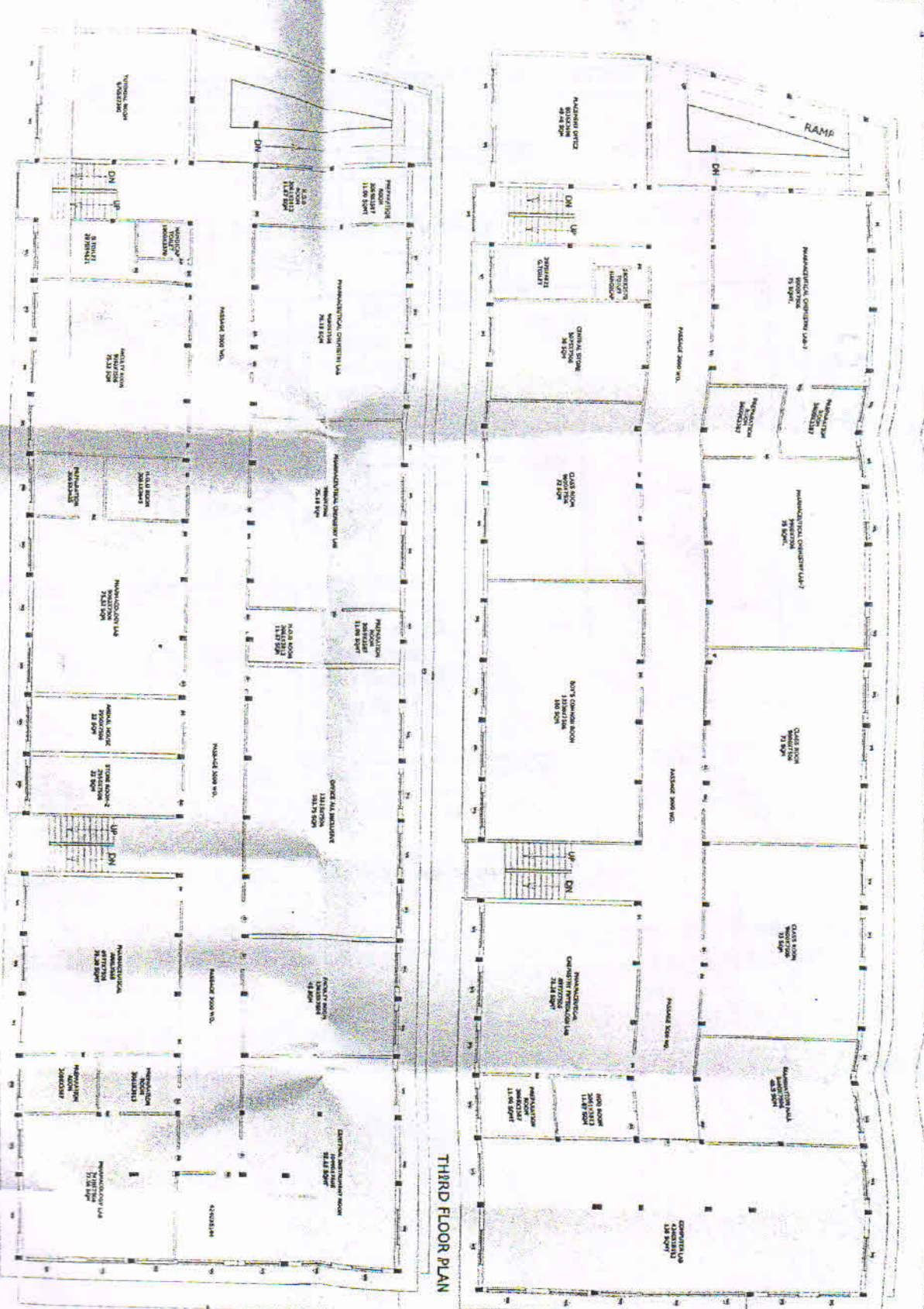

NOTES

1. THE OWNER IN THE PURSUANCE OF ANY AGREEMENT MADE IS NOT TO BE RESPONSIBLE FOR THE CONSTRUCTION OF THE BUILDING UNLESS OTHERWISE SPECIFIED IN THE CONTRACT DOCUMENTS. THE CONTRACTOR SHALL BE RESPONSIBLE FOR THE CONSTRUCTION OF THE BUILDING UNLESS OTHERWISE SPECIFIED IN THE CONTRACT DOCUMENTS.

PROPOSED SAI COLLEGE OF PHARMACY OF SRI SAI JAYSEVA NAGS SITUATED PLOT/GATE No.150, AT SIKTHIA, KRWAMAMAPUR, MAJILATH BHAYDAN, DIST-HAU (U.P.)

PHARMACY BLOCK BUILDUP AREA
 AREA OF GROUND FLOOR 1142.78 SQ.MT.
 AREA OF FIRST FLOOR 1142.78 SQ.MT.
 AREA OF SECOND FLOOR 1172.24 SQ.MT.
 AREA OF THIRD FLOOR 1172.24 SQ.MT.
 TOTAL BUILDUP AREA 4630.04 SQ.MT.

DOOR/WINDOW SCHEDULE

S. No.	TYPE	SIZE	CALL. NO.	UNIT/LIN.
1	D	1200X2100	1-20	2400
2	W	1200X2100	1-20	2100
3	D	900X2100	1-20	2100
4	W	1200X2100	1-20	2100
5	D	1200X2100	1-20	2100
6	W	1200X2100	1-20	2100
7	D	1200X2100	1-20	2100
8	W	1200X2100	1-20	2100
9	D	1200X2100	1-20	2100
10	W	1200X2100	1-20	2100

SCALE
 1:100
 OWNER'S SIGN

SHEET No. 03

ARCHITECT:
 A.B. ANAND MALVI
 CADRIKALAYA
 No. 28001 DINDOORAN, LTD

FOURTH FLOOR PLAN

THIRD FLOOR PLAN

(This sheet is for...
 intended to be...
 which is not...
 to be used...
 for any other...
 purpose...)