

GORAKHPUR INDUSTRIAL DEVELOPMENT AUTHORITY GORAKHPUR
 PLAN NO- CL-1 (INSTITUTIONAL) IN SECTOR NO-7
 ALLOTTED TO M/S PEOPLE EDUCATIONAL SOCIETY
 AREA- 40860.00 SQ.M. OR 10.10 ACRE

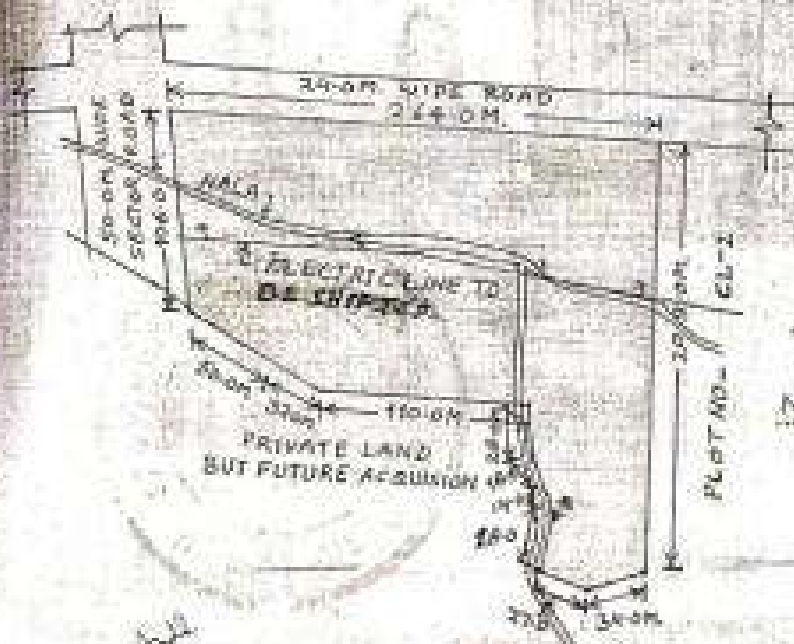

NOTE:- TREES AND PL. EXISTING
 ON THE PLOT BELONG TO
 FARMER.
 TREE - 9 NO.
 WEL - 2 NO.
 NOTE:- SITE IS UNDEVELOPED
 DIMENSION AND AREA OF
 PLOT IS AS PER LAYOUT MAP.
 DIMENSIONS AND AREA MAY
 DIFFER SLIGHTLY PER ACT-
 UAL MEASUREMENTS AT SITE.
 (SITE PLAN-PROVISIONAL)

THIRU INDUSTRIAL DEVELOPMENT AUTHORITY COBALTUR
 PLAN NO - C.I.D. INSTITUTIONAL BLDG NO - 7
 SET TO THE PEOPLE EDUCATIONAL SOCIETY
 AREA - 40850-00 SQ. M. OR 10.10 ACRES



NOTE: THIS IS UNDER
 DIMENSION AND
 THAT IS AS PER
 DIMENSION AND
 OTHER DETAILS
 AND PLEASE NOTE
 (SITE PLAN)

स्वसा चिह्न
 नाम.....
 पता.....

पता.....
 नाम.....

अवकाश क्रमांक २५५६

Handwritten notes in Hindi/English, including 'श्री २५५६' and other illegible text.



२०६